

Appendix B5

Collision Diagrams and Crash Data

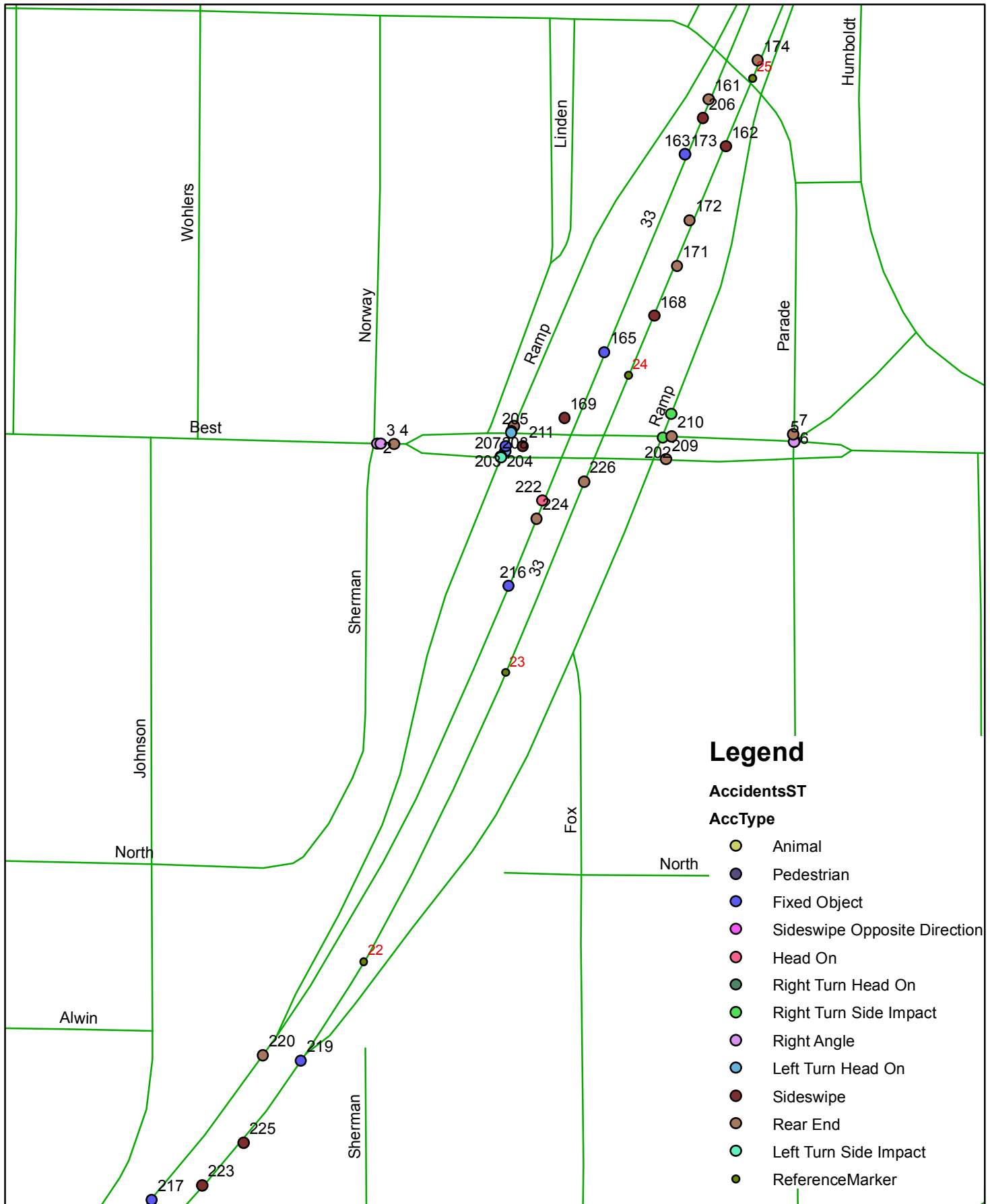

Legend

- AccidentsST**
- AccType**
- Animal
 - Pedestrian
 - Fixed Object
 - Sideswipe Opposite Direction
 - Head On
 - Right Turn Head On
 - Right Turn Side Impact
 - Right Angle
 - Left Turn Head On
 - Sideswipe
 - Rear End
 - Left Turn Side Impact
 - ReferenceMarker

LABELLA
Associates, D.P.C.

300 STATE STREET
ROCHESTER, NY 14614
P: (585) 454-6110
F: (585) 454-3066
www.labellapc.com
COPYRIGHT 2017

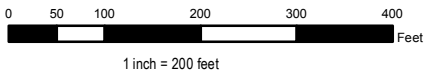

PROJECT/CLIENT

KENSINGTON EXPRESSWAY

PIN 5512.52
NYS DOT REGION 5

BUFFALO, NY

DRAWING TITLE

ACCIDENT LOCATIONS

DATE: 4/11/2017

PROJECT NUMBER
2150716.01

DRAWING
**EXHIBIT
C-1A**

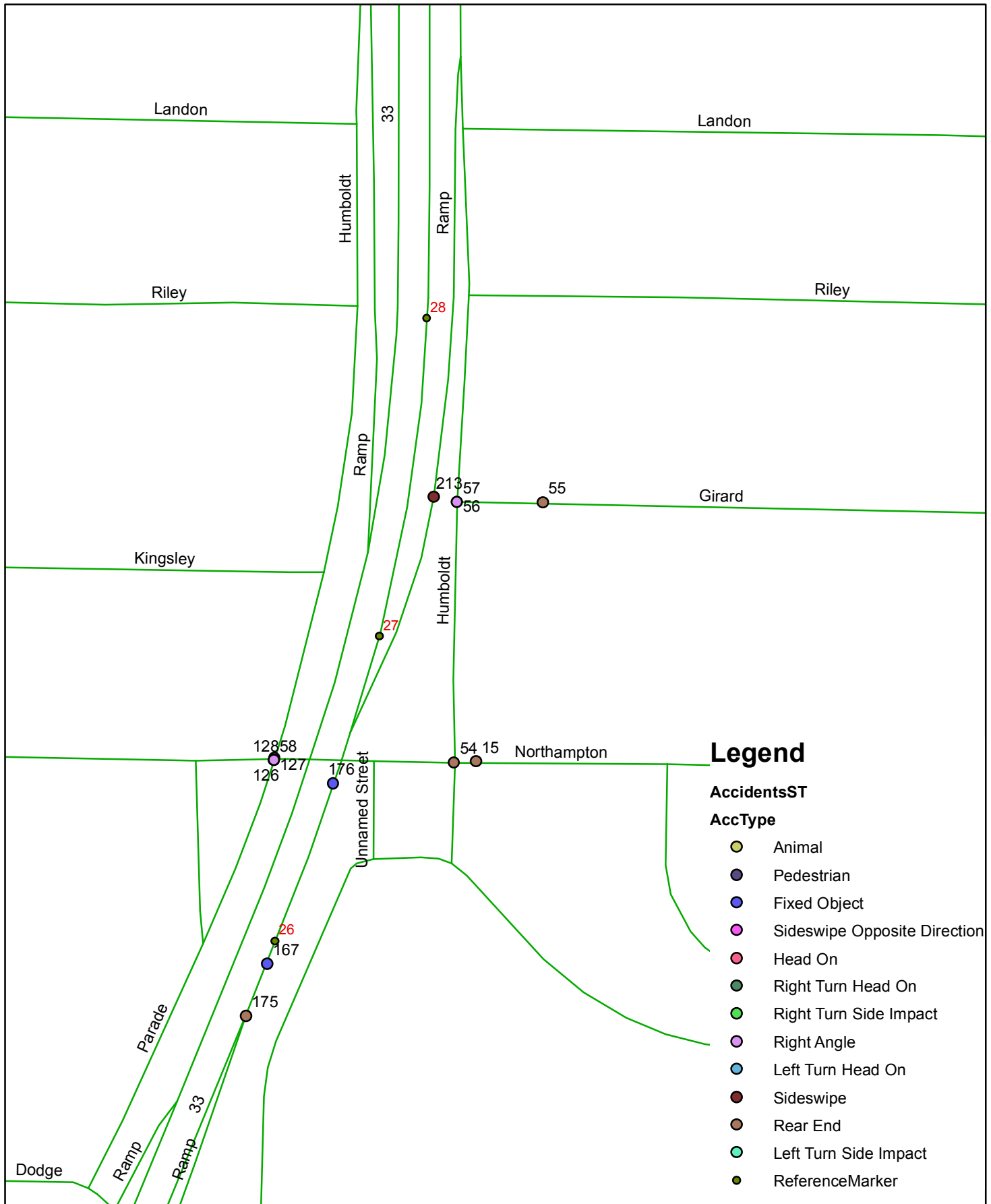

LABELLA
Associates, D.P.C.

300 STATE STREET
ROCHESTER, NY 14614
P: (585) 454-6110
F: (585) 454-3066
www.labellapc.com
COPYRIGHT 2017

0 50 100 200 300 400 Feet
1 inch = 200 feet

PROJECT/CLIENT
KENSINGTON EXPRESSWAY

PIN 5512.52
NYS DOT REGION 5

BUFFALO, NY

DRAWING TITLE
ACCIDENT LOCATIONS

DATE: 4/11/2017

PROJECT NUMBER
2150716.01

DRAWING
EXHIBIT C-1B

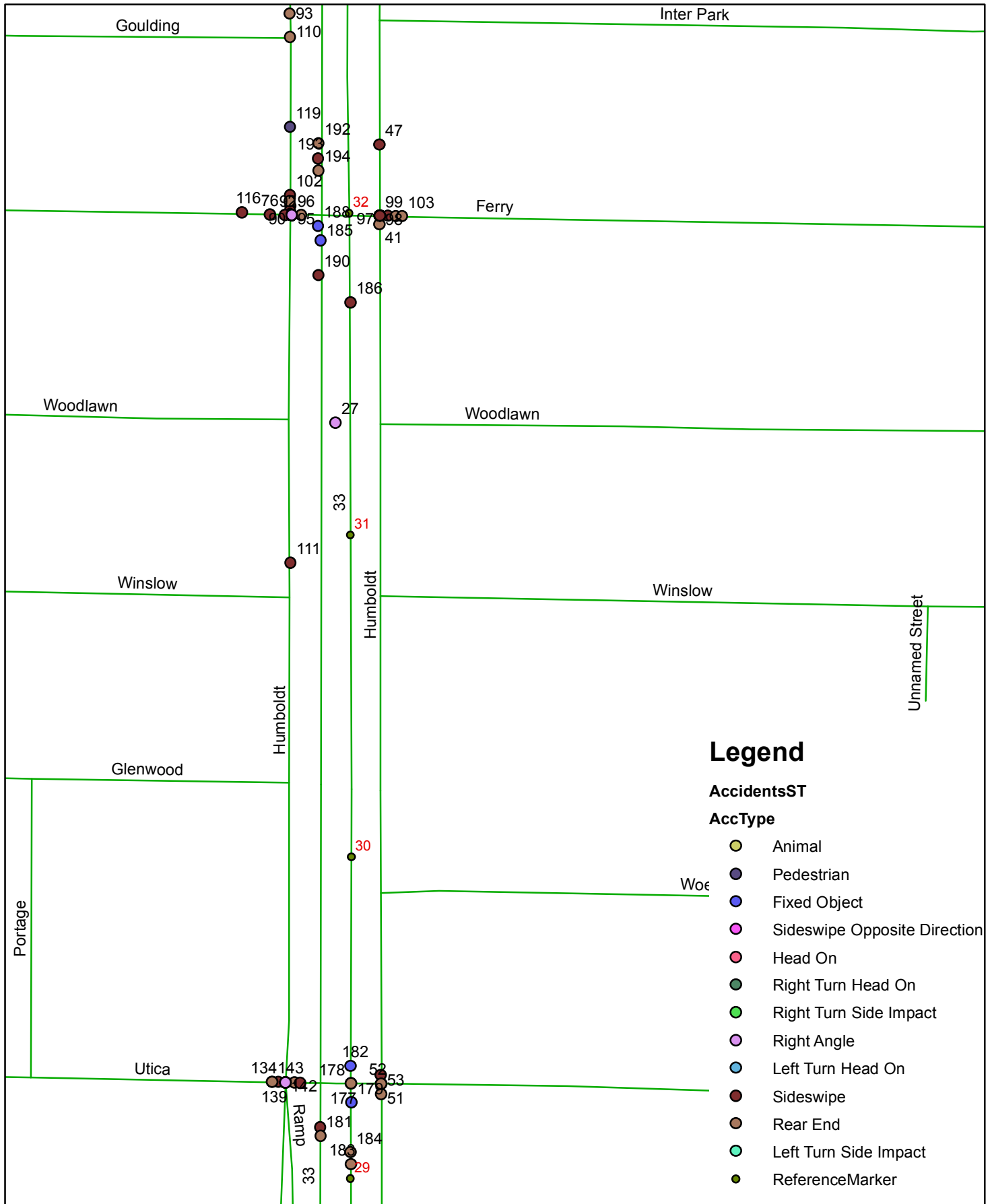

LABELLA
Associates, D.P.C.

300 STATE STREET
ROCHESTER, NY 14614
P: (585) 454-6110
F: (585) 454-3066
www.labellapc.com
COPYRIGHT 2017

0 50 100 200 300 400 Feet
1 inch = 200 feet

PROJECT/CLIENT
KENSINGTON EXPRESSWAY

PIN 5512.52
NYS DOT REGION 5

BUFFALO, NY

DRAWING TITLE
ACCIDENT LOCATIONS

DATE: 4/11/2017

PROJECT NUMBER
2150716.01

DRAWING
EXHIBIT C-1C

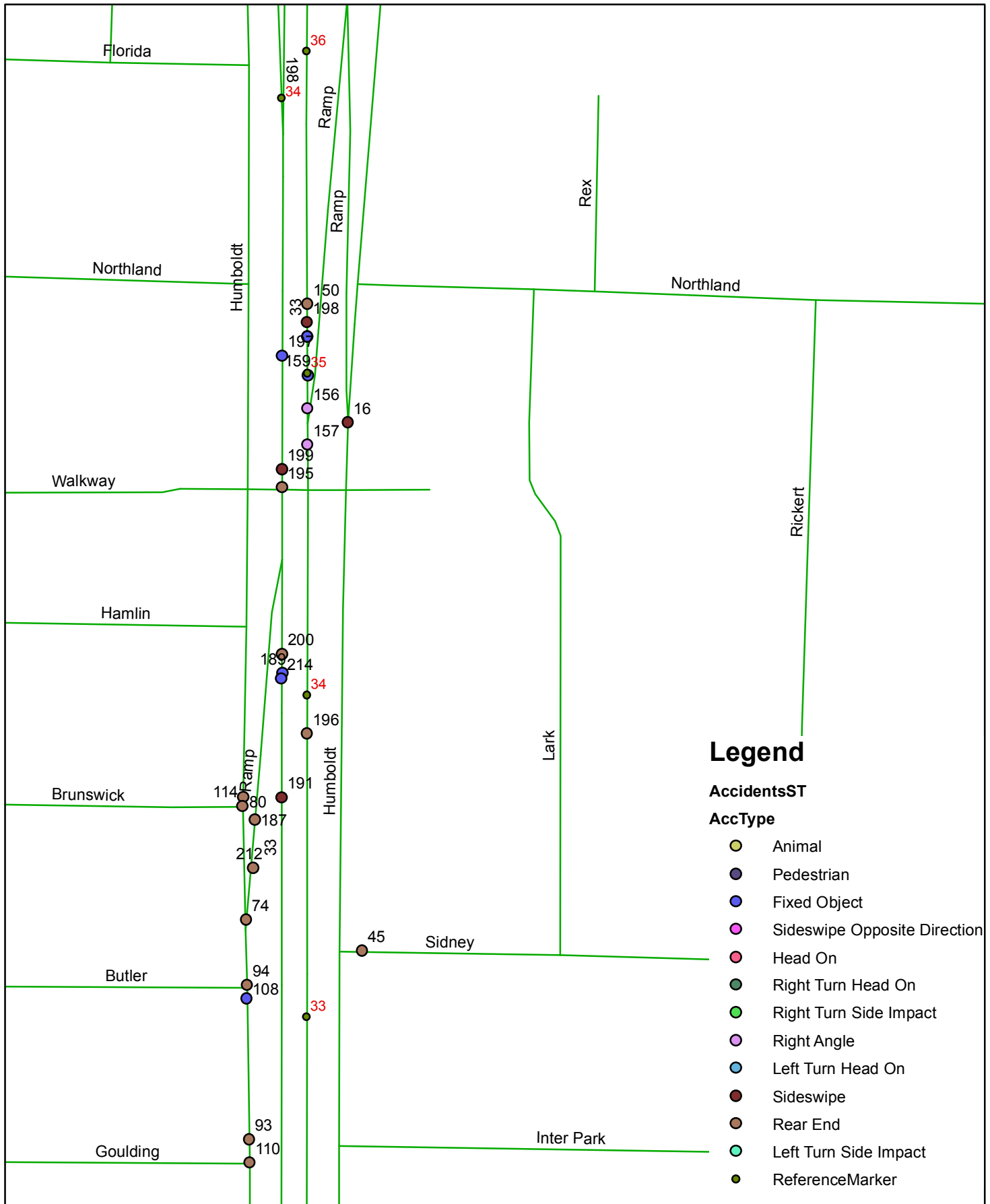

LABELLA
Associates, D.P.C.

300 STATE STREET
ROCHESTER, NY 14614
P: (585) 454-6110
F: (585) 454-3066
www.labellapc.com
COPYRIGHT 2017

0 50 100 200 300 400 Feet
1 inch = 200 feet

PROJECT/CLIENT
KENSINGTON EXPRESSWAY

PIN 5512.52
NYS DOT REGION 5

BUFFALO, NY

DRAWING TITLE
ACCIDENT LOCATIONS

DATE: 4/11/2017

PROJECT NUMBER
2150716.01

DRAWING
EXHIBIT C-1D

Id	Date	Day	AccType	PrimeSt	Intersect	AccDescr	Severity
2	2013-12-22	Sunday	Right Angle	Best St	Norway	Veh2 failed to yield ROW to Veh1 traveling EB on Best St	1
3	2014-02-28	Friday	Right Angle	Best St	Norway	Veh1 SB on Norway stopped at STOP sign then proceeded. Did not see Veh2 due to s	1
4	2015-04-01	Wednesday	Rear End	Best St	Norway	Veh1 slowed as approaching Veh2 stopped at signal. Veh1 struck rear of Veh2 when r	2
5	2014-10-24	Friday	Right Turn Head On	Best St	W Parade Ave	Veh2 made right turn onto W Parade when Veh1 made illegal left turn from W Parade.	2
6	2013-12-25	Wednesday	Right Angle	Best St	W Parade Ave	Veh1 SB on Parade struck Veh2 WB. Veh2 failed to stop for red light	1
7	2014-02-28	Friday	Rear End	W Parade Ave	Best	Veh2 stopped at red light when Veh1 ran into rear	1
15	2016-06-18	Saturday	Rear End	Northampton	Humboldt Pkwy N	Veh2 slowed to turn left when Veh1 approaching from rear failed to yield	2
16	2014-03-15	Saturday	Sideswipe	Humboldt Pkwy N	NY 198N Ramp	Veh1 sideswiped parked Veh2	1
32	2013-08-16	Friday	Left Turn Side Impa	Humboldt Pkwy N	E Ferry	Both vehicles NB, both turning left, Veh 2 cut in front of Veh1	1
33	2013-12-02	Monday	Right Angle	E Ferry	Humboldt Pkwy N	Veh1 EB on E Ferry was struck by Veh2. Veh1 alledgedly ran red light	2
34	2014-02-07	Friday	Right Angle	Humboldt Pkwy N	E Ferry	Veh1 EB on E Ferry ran red light struck Veh2	1
35	2014-02-02	Sunday	Right Angle	Humboldt Pkwy N	E Ferry	Right angle collision when one vehicle ran red light	2
36	2014-03-16	Sunday	Right Angle	E Ferry	Humboldt Pkwy N	Veh1 EB Veh2 NB someone ran red light	1
37	2014-05-18	Sunday	Right Angle	E Ferry	Humboldt Pkwy N	Veh1 NB and Veh2 EB collided in intersection. Both claim to have green light.	2
38	2014-07-08	Tuesday	Right Angle	E Ferry	Humboldt Pkwy N	Veh1 EB ran red light and struck Veh2 NB broadside which spun and struck Veh3 on E	2
39	2014-08-22	Friday	Right Angle	Humboldt Pkwy S	E Ferry	Veh2 WB on E Ferry with green indicatiion was struck by Veh1 SB on Humbltd thru red	2
40	2014-10-05	Sunday	Right Angle	E Ferry	Humboldt Pkwy N	Veh1 struck Veh2	1
41	2014-02-13	Friday	Rear End	Humboldt Pkwy N	E Ferry	Veh 1 stopped for red light, Veh2 following did not stop	2
42	2015-02-02	Monday	Right Angle	E Ferry	Humboldt Pkwy N	Veh1 tried to stop for red light but icy road caused to enter intersection where collision	1
43	2015-02-28	Saturday	Right Angle	Humboldt Pkwy N	E Ferry	Veh2 hit by Veh1 who had run red light	2
44	2015-05-26	Tuesday	Right Angle	E Ferry	Humboldt Pkwy S	Veh1 struck Veh2 not having stopped for red light	2
45	2015-08-28	Friday	Rear End	Sidney St	Humboldt Pkwy N	Veh2 stopped at stop sign Veh1 failed to stop and struck Veh2	1
46	2014-03-24	Monday	Right Angle	Humboldt Pkwy N	E Ferry	One vehicle ran red light and caused right angle accident	1
47	2015-11-15	Sunday	Sideswipe	Humboldt Pkwy N	E Ferry	Veh1 NB struck parked Veh2	1
48	2015-11-20	Friday	Right Angle	Humboldt Pkwy N	E Ferry	Veh1 passed stopped traffic, entered intersection and struck ambulance EB	2
49	2016-01-25	Monday	Right Angle	Humboldt Pkwy N	E Ferry	Veh1 EB struck Veh2 NB.	2
50	2016-03-03	Thursday	Right Angle	Humboldt Pkwy N	E Ferry	Veh1 NB struck Veh2 WB. Veh2 ran red light	2
51	2013-12-17	Tuesday	Right Angle	Humboldt Pkwy N	E Utica	Veh2 slid through red light and struck Veh1	1
52	2015-08-30	Sunday	Right Angle	Humboldt Pkwy N	E Utica	Veh1 failed to yield	2
53	2015-10-30	Friday	Rear End	Humboldt Pkwy N	E Utica	Veh2 stopped at red light while at intersection and Veh1 struck Veh2	2
54	2013-08-21	Wednesday	Rear End	Humboldt Pkwy N	Northampton	Veh2 hit Veh1 which was holding at signal	1
55	2014-05-14	Wednesday	Rear End	Girard	Humboldt Pkwy N	Veh 1 wrong way on Girard struck parked car which rolled and struck third car.	1
56	2015-08-02	Sunday	Right Angle	Girard	Humboldt Pkwy N	Veh1 failed to stop WB from Girard ran into guiderail along west side of Humboldt, the	1
57	2015-09-15	Tuesday	Right Angle	Girard	Humboldt Pkwy N	Veh did not see other veh coming and pulled into intersection	2
58	2015-11-27	Friday	Right Angle	Humboldt Pkwy S	Northampton	Veh1 WB ran red light striking Veh2	1
71	2013-09-14	Saturday	Right Angle	E Ferry	Humboldt Pkwy S	Veh1 WB struck Veh2 SB then spun and hit Veh3. Veh1 ran red light	2
72	2013-09-30	Monday	Rear End	E Ferry	Humboldt Pkwy S	Stopped at signal when hit by second veh	2
73	2013-12-15	Sunday	Right Angle	E Ferry	Humboldt Pkwy N	Veh entered intersection against red signal when unable to stop on icy conditions	2
74	2013-12-19	Thursday	Rear End	Humboldt Pkwy S	Brunswick	Exiting NY 33W when third car slowed abruptly, following failed to slow	1
75	2013-12-17	Tuesday	Rear End	Humboldt Pkwy S	E Ferry	Rear end one veh stopped following did not	1
76	2013-12-01	Sunday	Sideswipe	E Ferry	Humboldt Pkwy S	Veh1 turned right from left lane and struck Veh2 in right lane	2
77	2013-12-19	Thursday	Rear End	E Ferry	Humboldt Pkwy S	Veh1 hit Veh2 who then hit Veh3	2
78	2014-01-03	Friday	Right Angle	Humboldt Pkwy N	E Ferry	Veh1 NB failed to stop for red and struck Veh2(Bus) EB	2
79	2014-01-03	Friday	Sideswipe	E Ferry	Humboldt Pkwy N	Veh tried to pass with insufficient clearance	1

Id	Date	Day	AccType	PrimeSt	Intersect	AccDescr	Severity
80	2014-02-27	Thursday	Rear End	Humboldt Pkwy S	Brunswick	Both SB following struck leading Veh	1
81	2014-01-30	Thursday	Rear End	E Ferry	Humboldt Pkwy S	Veh skidded on ice and hit veh ahead stopped for traffic	1
82	2014-02-21	Friday	Sideswipe	Humboldt Pkwy S	E Ferry	Veh made right turn from thru lane striking veh in right turn lane	1
83	2014-04-01	Tuesday	Right Angle	Humboldt Pkwy S	E Ferry	Veh1 WB failed to stop on red and struck Veh2 SB	2
84	2014-05-01	Thursday	Right Angle	E Ferry	Humboldt Pkwy N	Veh1 NB struck Veh2 EB when it ran red light	2
85	2015-04-18	Friday	Right Angle	E Ferry	Humboldt Pkwy N	Veh1 WB struck Veh2 NB	2
86	2014-05-21	Wednesday	Right Angle	Humboldt Pkwy S	E Ferry	Veh1 WB struck Veh2 SB then struck Veh3 EB	2
87	2014-09-08	Monday	Right Angle	E Ferry	Humboldt Pkwy N	Veh1 WB ran red light and struck Veh2 NB	2
88	2014-09-13		Sideswipe	E Ferry	Humboldt Pkwy S	Veh collided when one changed lanes abruptly	1
89	2014-11-28	Friday	Rear End	E Ferry	Humboldt Pkwy N	Veh2 stopped for signal was struck by veh1.	1
90	2014-02-13	Friday	Rear End	Humboldt Pkwy S	E Ferry	Veh1 WB stopped at red light Veh2 failed to stop	2
91	2015-02-21	Saturday	Right Angle	E Ferry	Humboldt Pkwy N	Veh1 EB slid into intersection striking Veh2	2
92	2015-02-02	Monday	Right Turn Head On	E Ferry	Humboldt Pkwy S	Veh1 went wide while turning to WB E Ferry and struck Veh2 EB	1
93	2015-03-18	Wednesday	Rear End	Humboldt Pkwy S	Goulding	Veh1 SB brakes malfunctioned and struck Veh2 from behind	2
94	2015-04-19	Sunday	Rear End	Humboldt Pkwy S	Butler	Veh1 lost control when turning onto Butler ans struck two parked veh	1
95	2015-06-02	Tuesday	Right Turn Head On	E Ferry	Humboldt Pkwy S	Veh1 stopped EB when Veh2 SB righthturn went wide and struck Veh1	1
96	2015-04-25	Saturday	Right Turn Side Imp	E Ferry	Humboldt Pkwy S	Veh1 SB made right turn to WB Ferry and collided with Veh2 WB which ran the red light	2
97	2015-05-02	Saturday	Right Angle	E Ferry	Humboldt Pkwy N	Veh1 EB struck Veh2 NB. Both claim green light	2
98	2015-06-28	Sunday	Right Angle	E Ferry	Humboldt Pkwy N	Veh1 EB ran red light struck Veh2 NB then continued and struck Veh3	2
99	2015-07-07	Tuesday	Right Angle	E Ferry	Humboldt Pkwy N	Veh1 WB ran red light and struck Veh2 NB. Heavy rain	2
100	2015-06-16	Tuesday	Rear End	E Ferry	Humboldt Pkwy S	Veh1 SB ran into Veh2 SB	2
101	2015-07-19	Sunday	Right Angle	E Ferry	Humboldt Pkwy N	Veh1 NB struck Veh2 EB which then hit Veh3 WB stopped. Veh3 rolled backward and	2
102	2015-07-19	Sunday	Sideswipe	Humboldt Pkwy S	E Ferry	Veh1 driver fell asleep, sideswiped Veh2 then rear ended Veh3	2
103	2015-07-03	Friday	Rear End	E Ferry	Humboldt Pkwy N	Veh1 hit rear of Veh2	2
104	2015-08-13	Thursday	Right Angle	Humboldt Pkwy S	E Ferry	Veh1 EB ran red light and struck VEh2 SB	2
105	2015-09-02	Wednesday	Left Turn Head On	E Ferry	Humboldt Pkwy S	Veh2 SB making left turn to EB was struck by Veh1 WB ran red light	1
106	2015-09-04	Friday	Rear End	Humboldt Pkwy S	E Ferry	Veh1 and Veh2 both SB did collide	1
107	2015-09-09	Wednesday	Sideswipe	E Ferry	Humboldt Pkwy S	Veh1 (tractor trailer) swiped Veh2 (Kia)	1
108	2015-11-06	Friday	Fixed Object	Humboldt Pkwy S	Butler	Veh1 swerved to avoid another veh and lost control, exited street and struck house	2
109	2015-11-04	Wednesday	Right Angle	E Ferry	Humboldt Pkwy S	Veh1 SB collided with Veh2 EB. Someone ran red light	1
110	2015-11-12	Thursday	Rear End	Humboldt Pkwy S	Goulding	Veh1 SB was struck by Veh2 also SB	2
111	2015-11-14	Saturday	Sideswipe	Humboldt Pkwy S	Winslow	Veh1 SB swerved from lane and struck Veh2 parked	1
112	2015-11-24	Tuesday	Left Turn Side Impa	E Ferry	Humboldt Pkwy S	Veh2 SB ran red light to turn left and was struck by Veh1 EB	2
113	2015-12-06	Sunday	Sideswipe	E Ferry	Humboldt Pkwy N	Veh1 made right turn from left lane and did clip Veh2 which was in right lane	1
114	2015-11-28	Saturday	Rear End	Humboldt Pkwy S	Brunswick	Veh1 failed to stop following Veh2 which stopped for stop sign	2
115	2016-01-30	Saturday	Right Angle	E Ferry	Humboldt Pkwy S	Veh1 EB struck Veh2 SB when one of them ran red light	2
116	2016-02-27	Saturday	Sideswipe	E Ferry	Humboldt Pkwy S	Veh1 EB sideswiped parked veh then continued on to strike another parked veh	2
117	2016-03-04	Friday	Right Angle	Humboldt Pkwy S	E Ferry	Veh1 SB struck Veh2 WB. Both claim to have green.	2
118	2016-03-19	Saturday	Right Angle	Humboldt Pkwy S	E Ferry	Veh2 ran red light and struck Veh1	1
119	2016-04-26	Tuesday	Pedestrian	Humboldt Pkwy S	Goulding	veh backing out of driveway struck pedestrian then left the scene	2
120	2016-03-18	Friday	Right Angle	E Ferry	Humboldt Pkwy S	Veh1 SB struck Veh2 EB. Both claim green	2
121	2016-04-11	Monday	Rear End	E Ferry	Humboldt Pkwy S	Veh1 backed into Veh2 as both were stopped at signal	1

Id	Date	Day	AccType	PrimeSt	Intersect	AccDescr	Severity
122	2016-06-03	Friday	Right Angle	Humboldt Pkwy S	E Ferry	Veh2 SB Veh1 WB one of them ran red light	2
123	2016-06-26	Sunday	Right Angle	E Ferry	Humboldt Pkwy S	Veh2 ran red light EB was struck by Veh1 SB	2
124	2013-09-07	Saturday	Right Angle	Humboldt Pkwy S	Northampton	Veh2 WB was struck by Veh1 SB.	2
125	2014-08-31	Sunday	Rear End	Northampton	Humboldt Pkwy S	Veh1 did strike Veh2 which was stopped at intersection, then Veh 1 struck driver of Ve	2
126	2015-02-17	Tuesday	Rear End	Humboldt Pkwy S	Northampton	Very slippery roadway could not stop	1
127	2015-08-07	Friday	Right Angle	Northampton	Humboldt Pkwy S	Veh1 SB struck police car enroute to emergency WB	2
128	2015-08-30	Sunday	Right Angle	Northampton	Humboldt Pkwy S	Veh1 slid through stop sign and struck Veh2	2
129	2013-08-29	Thursday	Sideswipe	Humboldt Pkwy S	E Utica	Veh 2 stopped for veh1 waiting to make left from Humboldt Pkwy was sideswiped by tr	1
130	2013-10-06	Sunday	Rear End	E Utica	Humboldt Pkwy S	VEh2 stopped at signal WB when Veh1 rear end and fled west	2
131	2013-10-22	Tuesday	Right Angle	E Utica	Humboldt Pkwy S	Struck from Rt side front end	2
132	2013-12-02	Monday	Sideswipe	E Utica	Humboldt Pkwy S	Both veh making rt turn from adjacent lanes did collide	2
133	2014-02-09	Sunday	Sideswipe	Humboldt Pkwy N	E Utica	Veh2 NB preparing to park was struck by Veh1 NB	2
134	2014-08-06	Wednesday	Pedestrian	E Utica	Humboldt Pkwy S	Pedestrian waiting for bus was struck by veh backing out of driveway	2
135	2014-08-19	Tuesday	Rear End	Humboldt Pkwy S	E Utica	Veh2 rear ended Veh1 who was waiting at light	2
136	2015-04-07	Tuesday	Right Angle	E Utica	Humboldt Pkwy S	Veh1 on E Utica had green to make left when Veh2 ran red light	2
137	2015-06-07	Sunday	Right Angle	Humboldt Pkwy S	E Utica	Veh1 EB struck Veh2 SB	2
138	2015-06-25	Thursday	Right Angle	Humboldt Pkwy S	E Utica	Veh1 EB and Veh2 SB both claim green light	2
139	2015-07-23	Thursday	Right Angle	Humboldt Pkwy S	E Utica	Veh1 WB collided with Veh2 and Veh3 both SB. Veh 1 claims green	2
140	2015-09-05	Saturday	Rear End	Humboldt Pkwy N	E Utica	Veh2 stopped at light and Veh1 ran into Veh2	1
141	2015-10-17	Saturday	Sideswipe	E Utica	Humboldt Pkwy S	As Veh2 slowed to make left turn Veh1 swerved to go around but collided with Veh2	1
142	2015-11-10	Tuesday	Right Angle	Humboldt Pkwy S	E Utica	Veh1 SB collided with Veh2 WB	2
143	2016-01-09	Saturday	Rear End	E Utica	Humboldt Pkwy S	Veh2 did not move when light went green and Veh1 approaching did not stop and stru	2
164	2014-10-24	Friday	Rear End	Ramp NY 33W to B	Best	Following Veh failed to stop when lead veh slowed	1
201	2013-08-02	Friday	Left Turn Head On	Best St	NY 33W Exit Ramp	Veh2 making left turn onto Best was struck by Veh1 WB	1
202	2013-09-12	Thursday	Right Turn Side Imp	Best St	NY 33E on ramp	Veh1 turned right onto ramp and struck Veh2 NB through intersection from NY 33E ex	1
203	2014-06-10	Tuesday	Fixed Object	Best St	NY 33W Exit Ramp	Veh1 made left from ramp to Best St and struck median	2
204	2014-10-16	Thursday	Left Turn Side Impa	Best St	NY 33W Exit Ramp	Veh1 made left turn and was struck by Veh2 EB through intersection	1
205	2014-11-21	Friday	Left Turn Head On	Best St	NY 33W Exit Ramp	eh2 made left turn from ramp struck by Veh1 WB. Both claim green light	2
207	2015-04-28	Tuesday	Right Angle	Best St	NY 33W Exit Ramp	Veh2 bicycle EB hit by Veh1 SB. Veh1 alledged to run red light, also left scene	2
208	2015-07-10	Friday	Left Turn Side Impa	Best St	NY 33W exit ramp	Veh1 EB ran yellow when Veh2 made left turn before green	1
209	2015-09-22	Tuesday	Rear End	Best St	NY 33W on ramp	Veh1 accidentally stepped on gas	1
210	2016-02-29	Wednesday	Rear End	Best St	NY 33E on ramp	Following Veh failed to stop when lead veh slowed to merge	2
211	2016-04-10	Sunday	Sideswipe	Best St	NY 33W Exit ramp	Veh2 sideswiped in hit and run	1

Id	CaseID	Date	Day	AccType	Municip	PrimeSt	Intersect	AccDescr	Severity
27	35233198	2014-04-19	Saturday	4	Buffalo	NY 33	Woodlawn	Veh1 traveling EB (wrong way) on Woodlawn at high rate of s	3
150	34933825	2013-09-05	Thursday	1	Buffalo	NY 33E	Ramp to NY 198	Veh2 changed lanes suddenly causing Veh1 to strike Veh2 w	1
155	35119587	2013-12-24	Tuesday	9	Buffalo	NY 33E	NY 198 Ramp	VEh hit icy spot spun out and hit wall	1
156	35191324	2014-02-27	Thursday	4	Buffalo	NY 33E	198 WB	Veh1 spunout on ice and hit Veh	1
157	35659216	2015-02-14	Saturday	4	Buffalo	NY 33E	NY 198 ramp	Veh2 alledges being clipped by unkown third veh causing to s	2
159	35721692	2015-03-30	Monday	9	Buffalo	NY 33E	198 exit	Veh locked brakes and lost control then struck median barrier	1
160	35848436	2015-07-06	Monday	9	Buffalo	NY 33E	Ramp 198	Veh1 lost control when changing lanes and struck the wall th	2
161	35195673	2014-01-29	Wednesday	1	Buffalo	NY 33W	Best St	Traffic stopped quickly due to another accident. Veh2 could r	1
162	35169728	2014-02-01	Saturday	2	Buffalo	NY 33	Best St	Veh1 clipped Veh2 then spun out and struck wall	1
163	35239266	2014-03-29	Saturday	9	Buffalo	NY 33W	Best St	Spun out and struck wall on right	2
165	35655167	2015-01-07	Wednesday	9	Buffalo	NY 33W	Best St	Car slid and hit wall on right	1
167	35119757	2013-12-26	Thursday	9	Buffalo	NY 33E		Veh hit patch of ice and lost control hitting guiderail	1
168	35171144	2014-01-29	Wednesday	2	Buffalo	NY 33E	Best St	Veh1 lost control wile changing lanes and struck Veh2	1
169	35205823	2014-02-27	Thursday	2	Buffalo	NY 33	Best St	Icy conditions caused Veh1 to spin out striking Veh2	1
170	35390664	2014-08-07	Thursday	5	Buffalo	Ramp NY 33E	Best St	Both veh attempted to occupy the same lane	1
171	35659431	2015-01-07	Wednesday	1	Buffalo	NY 33E	Best St	Both Veh EB when following struck leading, causing leading	2
172	35719863	2015-03-07	Saturday	1	Buffalo	NY 33E	Best St	Veh1 traveling high rate struck Veh2 causing spin then proce	1
173	35786074	2015-04-21	Tuesday	9	Buffalo	NY 33W	Best Ramp	Veh1 was cut off and hit brakes, which caused loss of control	1
174	36030094	2015-11-30	Monday	1	Buffalo	NY 33E	Best St	Following Veh failed to stop when lead veh slowed	1
175	36292197	2016-05-26	Thursday	1	Buffalo	NY 33E		Following Veh failed to stop when lead veh slowed	1
176	35113975	2014-12-14	Saturday	9	Buffalo	NY 33E	Northampton	Veh1 spun out on ice	2
177	34954870	2013-09-30	Monday	9	Buffalo	NY 33E	E Utica	Veh1 swerved to avoid Veh2 and lost control and hit median	1
178	35113976	2013-12-14	Saturday	1	Buffalo	Ramp NY 33E	E Utica	Following Veh failed to stope when lead veh slowed	2
179	35122272	2014-01-03	Friday	9	Buffalo	NY 33E	E Utica	Veh spun out on ice then struck wall	2
180	35171548	2014-01-21	Tuesday	2	Buffalo	NY 33W	E Utica	Veh1 swerved to avoid a third veh cutting into middle lane an	1
181	35171391	2014-02-02	Sunday	1	Buffalo	NY 33W	E Utica	Veh1 came to stop in middle lane, Veh2 could not stop and s	1
182	35660932	2015-02-04	Wednesday	9	Buffalo	NY 33E	E Utica	Veh1 spun on ice then hit barrier	2
183	35651147	2015-02-21	Saturday	1	Buffalo	NY 33E	E Utica	Following Veh failed to stop when lead veh slowed	2
184	35855107	2015-08-04	Tuesday	1	Buffalo	NY 33E	E Utica	Following Veh failed to stope when lead veh slowed	1
185	35467160	2014-10-11	Saturday	9	Buffalo	NY 33W	S of E Ferry	Veh1 change lanes from left to right, lost control, clipped Veh	2
186	35764188	2015-06-11	Thursday	2	Buffalo	NY 33E	0.5 mi S of NY198	Veh1 changed lanes and clipped Veh2	1
187	34942036	2013-08-07	Wednesday	1	Buffalo	NY 33W	Ferry St Ramp	Following Veh failed to stope when lead veh slowed for const	1
188	34954852	2013-09-29	Sunday	9	Buffalo	NY 33W	E Ferry	Veh1 swerved to right and struck wall then swerved left and s	2
189	35033645	2013-11-11	Monday	9	Buffalo	NY 33W	E of Ferry St Ramp	Veh1 lost traction on wet pavement and struck median barrier	2
190	35181219	2014-02-11	Tuesday	2	Buffalo	NY 33W	E Ferry	Both veh collided when attempting to merge into same lane c	2
191	35207335	2014-02-27	Thursday	2	Buffalo	NY 33W	Ferry St Ramp	Veh2 attempted to pass on right on the shoulder and swiped V	1
192	35658215	2015-02-17	Tuesday	1	Buffalo	NY 33W	E Ferry	Following Veh failed to stop when lead veh slowed for disable	2
193	35848965	2015-07-25	Saturday	2	Buffalo	NY 33W	E Ferry	Veh1 struck side of Veh2 when passing, Veh1 hit median	1
194	35945281	2015-10-03	Saturday	1	Buffalo	NY 33W	E Ferry	Following Veh failed to stope when lead veh slowed	2
195	36227823	2016-05-12	Thursday	1	Buffalo	NY 33W	N of E Ferry Ramp	Following Veh failed to stope when lead veh slowed to merge	2
196	34938753	2013-09-17	Tuesday	1	Buffalo	NY 33E		Following Veh failed to stope when lead veh slowed for traffic	2
197	35194570	2014-02-16	Sunday	9	Buffalo	NY 33W	E Delevan	Veh1 slid on pavement striking snow pile on west side of road	2
198	35025467	2013-10-24	Tuesday	2	Buffalo	NY 33E	S of NY 198	Veh2 struck Veh1 while passing on left	1
199	35281184	2014-05-30	Friday	2	Buffalo	NY 33W	Ferry St Ramp	Veh1 struck Veh2 while changing lanes	1
200	35783325	2015-06-11	Thursday	1	Buffalo	NY 33W		Following Veh failed to stope when lead veh slowed for traffic	1
206	35585986	2014-11-23	Sunday	2	Buffalo	NY 33W	Best St	Hit and run sideswipe on expressway	2
212	35837102	2015-08-06	Thursday	1	Buffalo	Ramp NY 33W	Exit to E Ferry St	Following Veh failed to stope when lead veh slowed to merge	2
213	35209742	2014-02-27	Thursday	2	Buffalo	Ramp NY 33E		Veh1 attempted to pass on left on ramp with no clearance	1
214	35595903	2014-11-28	Friday	9	Buffalo	NY 33W	Humboldt Exit	Veh1 WB lost control and hit guide rail	1

216	35027188	2013-11-01	Friday	9	Buffalo	NY 33W	Best St	Veh2 changed lanes into Veh1 path causing Veh1 to swerve	2
217	35088175	2013-11-28	Thursday	9	Buffalo	NY 33W	High St	Veh1 struck wall	2
218	35088142	2013-11-29	Friday	9	Buffalo	NY 33E	High St	Veh1 swerved to avoid Veh2 and hit barrier	2
219	35151189	2014-01-13	Wednesday	9	Buffalo	NY 33E	Best St Ramp	Hit tool box in road	1
220	35213546	2014-03-28	Friday	1	Buffalo	NY 33W	Best St On Ramp	Veh1 struck veh2 while attempting to pass on left then struck	1
222	35235473	2014-04-07	Monday	7	Buffalo	NY 33W	Best St	Veh1 hit wall then spun and was struck by Veh2	1
223	35458542	2014-09-24	Wednesday	2	Buffalo	NY 33	High St		1
224	35606860	2015-01-08	Thursday	1	Buffalo	NY 33W	Best St		2
225	36206479	2016-04-29	Friday	2	Buffalo	NY 33E	Best St Exit Ramp	Veh in left lane and veh in middle lane collided causing veh 2	2
226	36316109	2016-06-24	Friday	1	Buffalo	NY 33E	Best St	Veh2 rearended then veh1 fled scene	2

INTERSECTION ACCIDENT RATE CALCULATIONS

$$\text{Rate per MEV} = \frac{\# \text{ of Accidents} \times 1,000,000}{\text{Total No. of Entering Vehicles}} =$$

$$\text{Rate} = \frac{\# \text{ of Accidents} \times 1,000,000}{\text{Veh./Day} \times \text{Duration of Study}} =$$

Accidents per million entering vehicles (Acc / MEV)

ADT = Peak hour entering volume / k factor

*Accident data is from July 1, 2013 to June 30, 2016

1. NY 33E Ramps Best St

$$\text{ADT} = 1818 \text{ VPH} / 0.09 = 21140 \text{ VPD}$$

$$\text{Rate} = \frac{4 \text{ Acc.} \times 1,000,000}{21140 \text{ VPD} \times 365 \text{ Days} \times 3.00 \text{ Yrs.}} = 0.17 \text{ Acc / MEV}$$

2. Humboldt Pkwy N Northampton St

$$\text{ADT} = 246 \text{ VPH} / 0.08 = 3075 \text{ VPD}$$

$$\text{Rate} = \frac{2 \text{ Acc.} \times 1,000,000}{3075 \text{ VPD} \times 365 \text{ Days} \times 3.00 \text{ Yrs.}} = 0.59 \text{ Acc / MEV}$$

3. Humboldt Pkwy N E Utica St

$$\text{ADT} = 685 \text{ VPH} / 0.08 = 8782.1 \text{ VPD}$$

$$\text{Rate} = \frac{5 \text{ Acc.} \times 1,000,000}{8782.1 \text{ VPD} \times 365 \text{ Days} \times 3.00 \text{ Yrs.}} = 0.52 \text{ Acc / MEV}$$

4. Humboldt Pkwy N E Ferry St

$$\text{ADT} = 1193 \text{ VPH} / 0.08 = 14913 \text{ VPD}$$

$$\text{Rate} = \frac{29 \text{ Acc.} \times 1,000,000}{14913 \text{ VPD} \times 365 \text{ Days} \times 3.00 \text{ Yrs.}} = 1.78 \text{ Acc / MEV}$$

INTERSECTION ACCIDENT RATE CALCULATIONS

$$\text{Rate per MEV} = \frac{\# \text{ of Accidents} \times 1,000,000}{\text{Total No. of Entering Vehicles}} =$$

$$\text{Rate} = \frac{\# \text{ of Accidents} \times 1,000,000}{\text{Veh./Day} \times \text{Duration of Study}} =$$

Accidents per million entering vehicles (Acc / MEV)

ADT = Peak hour entering volume / k factor

*Accident data is from July 1, 2013 to June 30, 2016

5. **NY 33W Ramps** **Best St**

 ADT = 1306 VPH / 0.09 = 15186 VPD

Rate = $\frac{9 \text{ Acc.} \times 1,000,000}{15186 \text{ VPD} \times 365 \text{ Days} \times 3.00 \text{ Yrs.}}$ = 0.54 Acc / MEV

6. **Humboldt Pkwy S** **Northampton St**

 ADT = 330 VPH / 0.08 = 4125 VPD

Rate = $\frac{6 \text{ Acc.} \times 1,000,000}{4125 \text{ VPD} \times 365 \text{ Days} \times 3.00 \text{ Yrs.}}$ = 1.33 Acc / MEV

7. **Humboldt Pkwy S** **E Utica St**

 ADT = 750 VPH / 0.08 = 9375 VPD

Rate = $\frac{13 \text{ Acc.} \times 1,000,000}{9375 \text{ VPD} \times 365 \text{ Days} \times 3.00 \text{ Yrs.}}$ = 1.27 Acc / MEV

8. **Humboldt Pkwy S** **E Ferry St**

 ADT = 1074 VPH / 0.08 = 13425 VPD

Rate = $\frac{30 \text{ Acc.} \times 1,000,000}{13425 \text{ VPD} \times 365 \text{ Days} \times 3.00 \text{ Yrs.}}$ = 2.04 Acc / MEV

9. **Best Street** **W Parade Ave**

 ADT = 1504 VPH / 0.08 = 18800 VPD

Rate = $\frac{3 \text{ Acc.} \times 1,000,000}{18800 \text{ VPD} \times 365 \text{ Days} \times 3.00 \text{ Yrs.}}$ = 0.15 Acc / MEV

ROADWAY SEGMENT (MID-BLOCK) ACCIDENT RATE CALCULATIONS

$$\text{Rate per MVM} = \frac{\text{\# of Accidents} \times 1,000,000}{\text{Total Vehicle Miles of Travel}}$$

$$\text{Rate} = \frac{\text{\# of Accidents} \times 1,000,000}{\text{Sectional Length} \times \text{AADT} \times \text{Duration of Study}}$$

Accidents per million vehicle miles (Acc / MVM)

1. Kensington Expressway- High Street to E Utica Street

Section length = 0.810 mi
2 - way ADT = 71402

$$\text{Rate} = \frac{28 \text{ Acc.} \times 1,000,000}{0.810 \text{ mi} \times 71402 \text{ VPD} \times 365 \text{ Days} \times 3.00 \text{ Yrs.}} = 0.44 \text{ Acc / MVM}$$

2. Kensington Expressway - E Utica St to Northland Ave

Section length = 0.600 mi
2 - way ADT = 76566

$$\text{Rate} = \frac{24 \text{ Acc.} \times 1,000,000}{0.600 \text{ mi} \times 76566 \text{ VPD} \times 365 \text{ Days} \times 3.00 \text{ Yrs.}} = 0.48 \text{ Acc / MVM}$$

ROADWAY SEGMENT (MID-BLOCK) ACCIDENT RATE CALCULATIONS

$$\text{Rate per MVM} = \frac{\text{\# of Accidents} \times 1,000,000}{\text{Total Vehicle Miles of Travel}}$$

$$\text{Rate} = \frac{\text{\# of Accidents} \times 1,000,000}{\text{Sectional Length} \times \text{AADT} \times \text{Duration of Study}}$$

Accidents per million vehicle miles (Acc / MVM)

1. Humboldt Parkway SB- Northampton Street to E Ferry Street

Section length = 0.780 mi
1 - way ADT = 4222

$$\text{Rate} = \frac{24 \text{ Acc.} \times 1,000,000}{0.780 \text{ mi} \times 4222 \text{ VPD} \times 365 \text{ Days} \times 3.00 \text{ Yrs.}} = 6.66 \text{ Acc / MVM}$$

2. Humboldt Parkway SB - E Ferry St to Northland Ave

Section length = 0.300 mi
1 - way ADT = 6100

$$\text{Rate} = \frac{14 \text{ Acc.} \times 1,000,000}{0.300 \text{ mi} \times 6100 \text{ VPD} \times 365 \text{ Days} \times 3.00 \text{ Yrs.}} = 6.99 \text{ Acc / MVM}$$

3. Humboldt Parkway NB- Northampton Street to E Ferry Street

Section length = 0.780 mi
1 - way ADT = 3550

$$\text{Rate} = \frac{28 \text{ Acc.} \times 1,000,000}{0.780 \text{ mi} \times 3550 \text{ VPD} \times 365 \text{ Days} \times 3.00 \text{ Yrs.}} = 9.23 \text{ Acc / MVM}$$

4. Humboldt Parkway NB - E Ferry St to Northland Ave

Section length = 0.300 mi
1 - way ADT = 6135

$$\text{Rate} = \frac{3 \text{ Acc.} \times 1,000,000}{0.300 \text{ mi} \times 6135 \text{ VPD} \times 365 \text{ Days} \times 3.00 \text{ Yrs.}} = 1.49 \text{ Acc / MVM}$$

DEPARTMENT OF TRANSPORTATION COLLISION DIAGRAM

MUNICIPALITY	CITY OF BUFFALO	COUNTY	ERIE	FILE	Exp³ess ay Accident Diag³ams.dgn
INTERSECTION	KENSINGTON EXPRESSWAY - NY33				
PERIOD	3 YR 0 MO	FROM	08 / 01 / 2013	TO	07 / 31 / 2016
		BY	CAE	DATE	4 / 11 / 2017

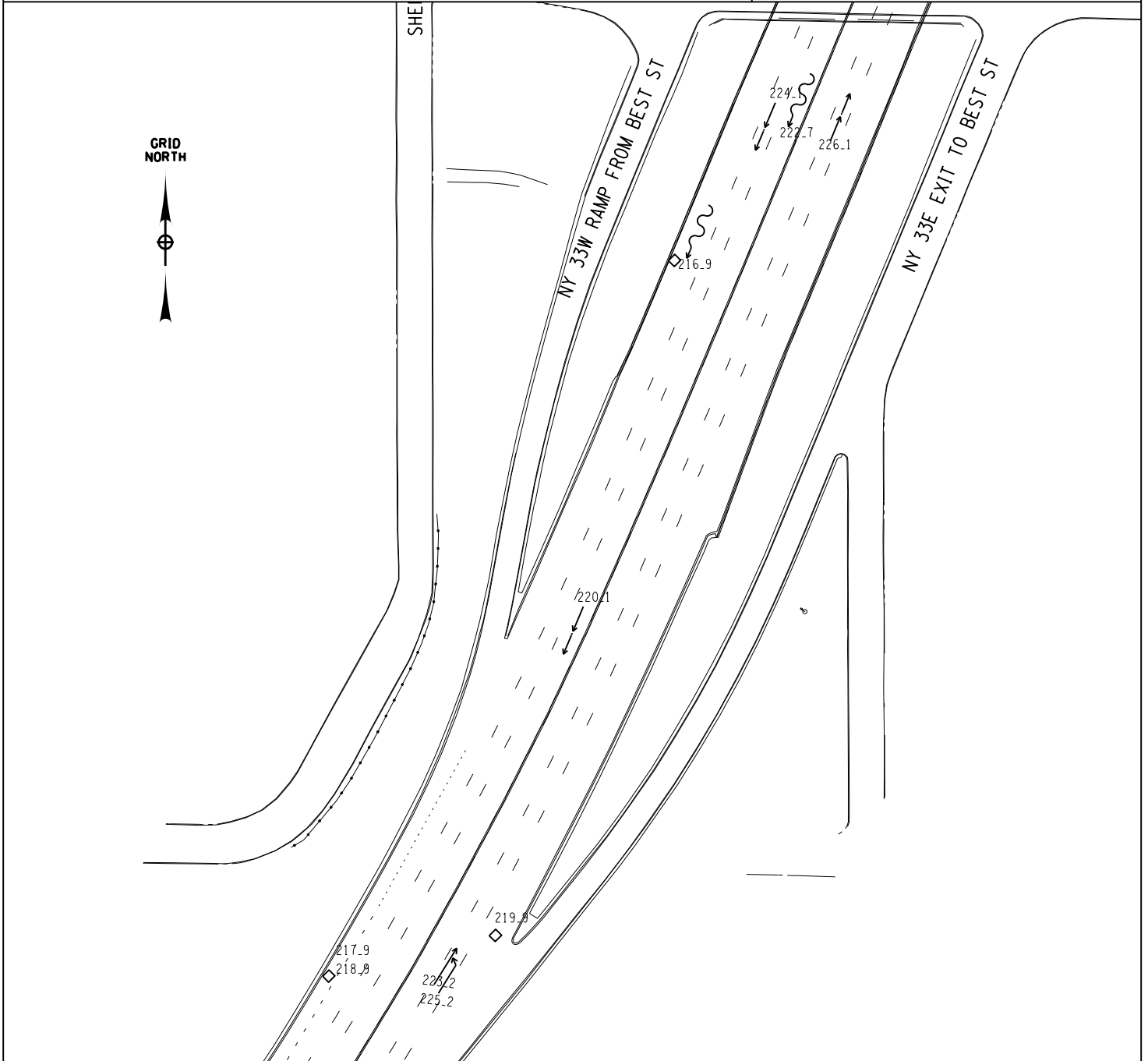

SYMBOLS

MANNER OF COLLISION

<ul style="list-style-type: none"> ← MOVING VEHICLE ← M ← MOTORCYCLE ← → → → BACKING VEHICLE ← ● STOPPED VEHICLE ▭ PARKED VEHICLE ← - - - PEDESTRIAN ← B - BICYCLE □ FIXED OBJECT ○ PERSONAL INJURY ● FATAL INJURY 	<ul style="list-style-type: none"> ← ← REAR-END ← → SIDE-SWIPE ← ~ OUT OF CONTROL ← ~ SKIDDING ← ○ OVERTURNED → → HEAD-ON → ↙ LEFT-TURN → ↓ RIGHT-ANGLE
--	---

DEPARTMENT OF TRANSPORTATION COLLISION DIAGRAM

MUNICIPALITY	CITY OF BUFFALO	COUNTY	ERIE	FILE	Exp ³ ess ay Accident Diag ³ ams.dgn
INTERSECTION	KENSINGTON EXPRESSWAY - NY33				
PERIOD	3 YR 0 MO	FROM	08 / 01 / 2013	TO	07 / 31 / 2016
		BY	CAE	DATE	4 / 11 / 2017

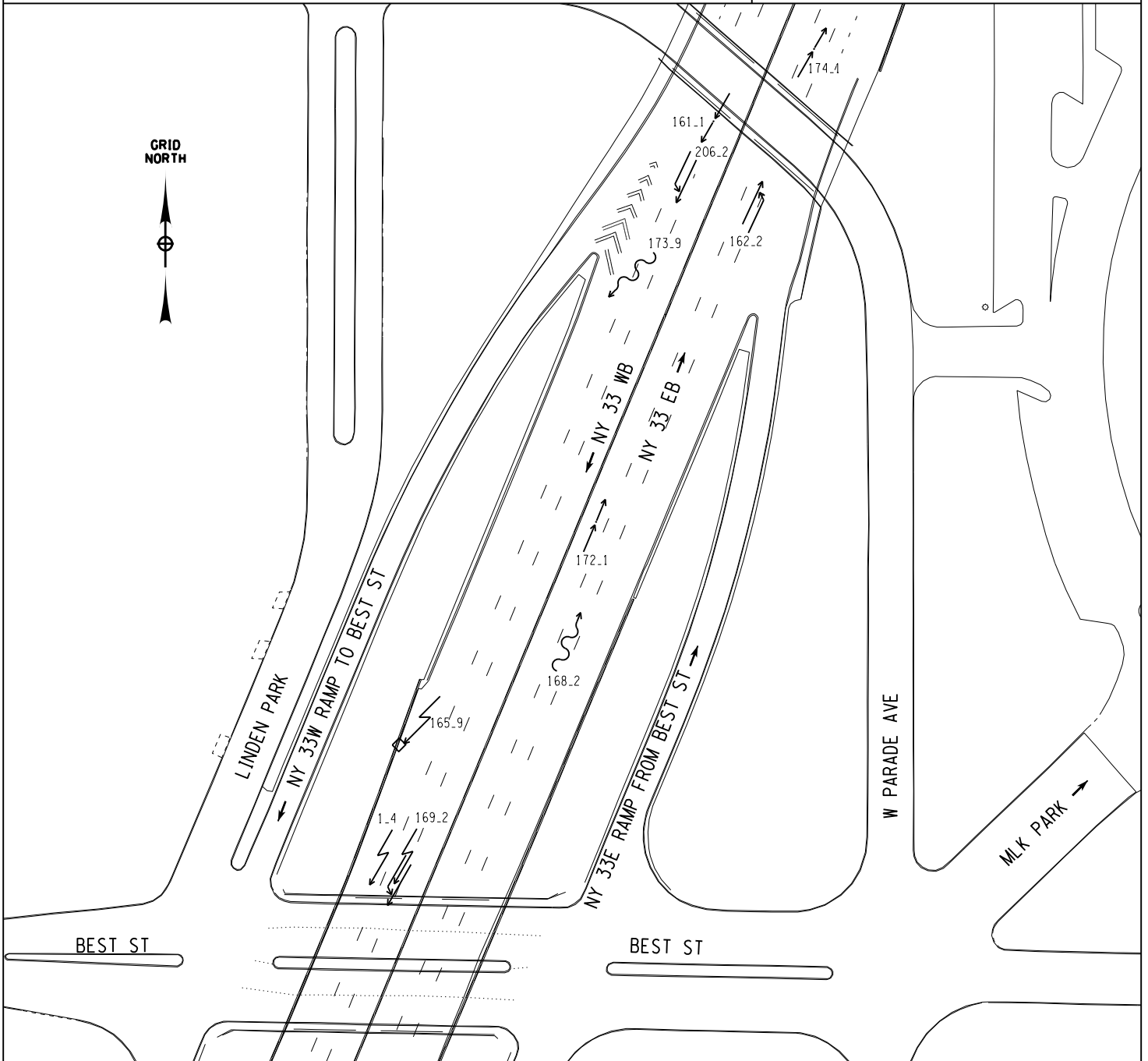

SYMBOLS

MANNER OF COLLISION

<ul style="list-style-type: none"> ← MOVING VEHICLE ← M ← MOTORCYCLE ← → → → BACKING VEHICLE ← ● STOPPED VEHICLE ▭ PARKED VEHICLE ← - - PEDESTRIAN ← B ← BICYCLE □ FIXED OBJECT ○ PERSONAL INJURY ● FATAL INJURY 	<ul style="list-style-type: none"> ← ← REAR-END ← → SIDE-SWIPE ← ~ OUT OF CONTROL ← ~ SKIDDING ← ○ OVERTURNED → ← HEAD-ON → ↙ LEFT-TURN → ↓ RIGHT-ANGLE
--	---

DEPARTMENT OF TRANSPORTATION COLLISION DIAGRAM

MUNICIPALITY	CITY OF BUFFALO	COUNTY	ERIE	FILE	Exp ³ ess ay Accident Diag ³ ams.dgn
INTERSECTION	KENSINGTON EXPRESSWAY - NY33				
PERIOD	3 YR 0 MO	FROM	08 / 01 / 2013	TO	07 / 31 / 2016
		BY	CAE	DATE	4 / 11 / 2017

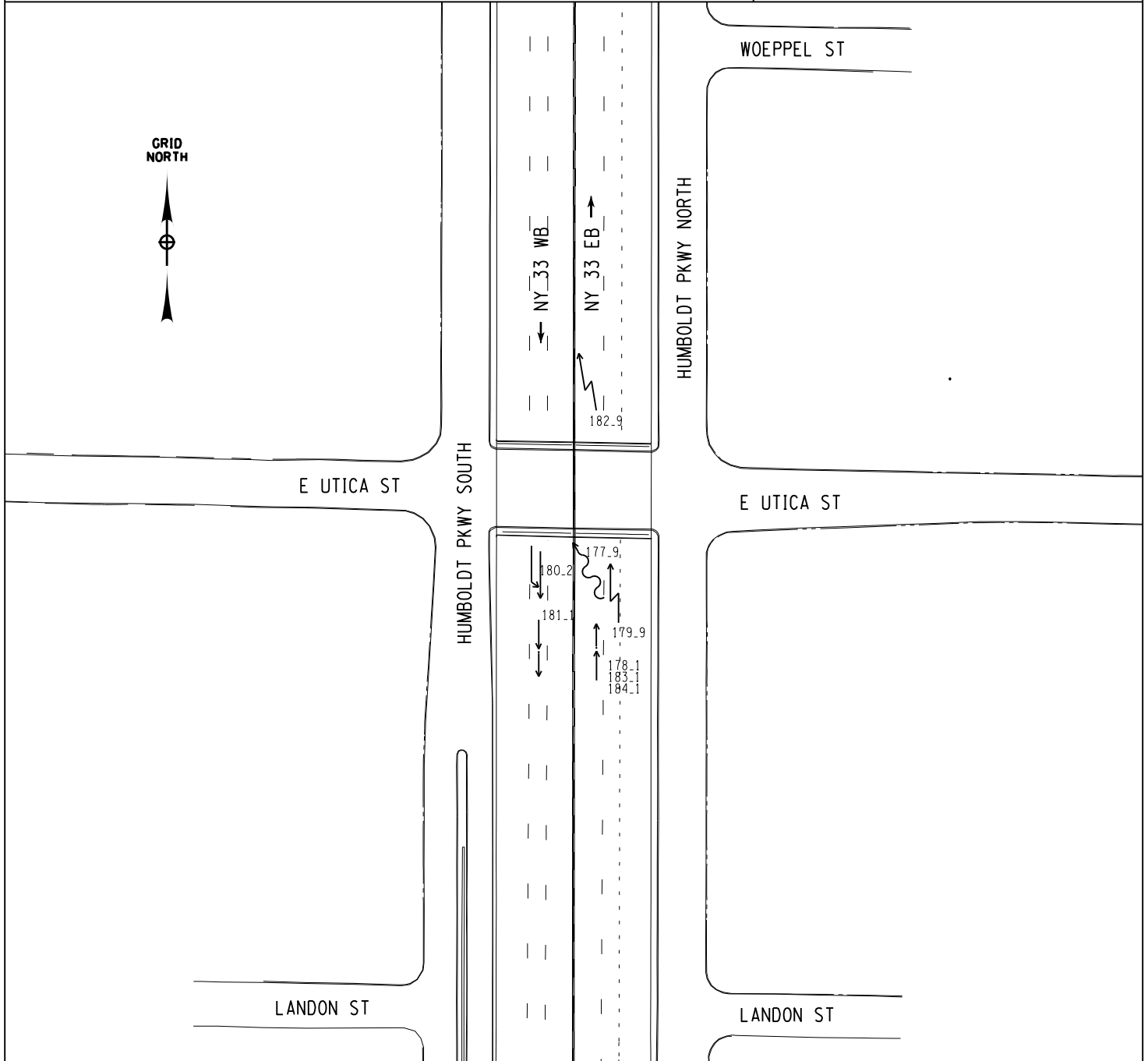

SYMBOLS

<p>← MOVING VEHICLE</p> <p>← M ← MOTORCYCLE</p> <p>← → → → BACKING VEHICLE</p> <p>← ● STOPPED VEHICLE</p> <p>▭ PARKED VEHICLE</p>	<p>← - - PEDESTRIAN</p> <p>← B ← BICYCLE</p> <p>□ FIXED OBJECT</p> <p>○ PERSONAL INJURY</p> <p>● FATAL INJURY</p>
---	---

MANNER OF COLLISION

<p>← ← REAR-END</p> <p>← → SIDE-SWIPE</p> <p>← ~ OUT OF CONTROL</p> <p>← ⚡ SKIDDING</p> <p>← ○ OVERTURNED</p>	<p>→ → HEAD-ON</p> <p>→ ↙ LEFT-TURN</p> <p>→ ↓ RIGHT-ANGLE</p>
---	--

DEPARTMENT OF TRANSPORTATION COLLISION DIAGRAM

MUNICIPALITY	CITY OF BUFFALO	COUNTY	ERIE	FILE	Exp ³ ess ay Accident Diag ³ ams.dgn
INTERSECTION	KENSINGTON EXPRESSWAY - NY33				
PERIOD	3 YR 0 MO	FROM	08 / 01 / 2013	TO	07 / 31 / 2016
		BY	CAE	DATE	4 / 11 / 2017

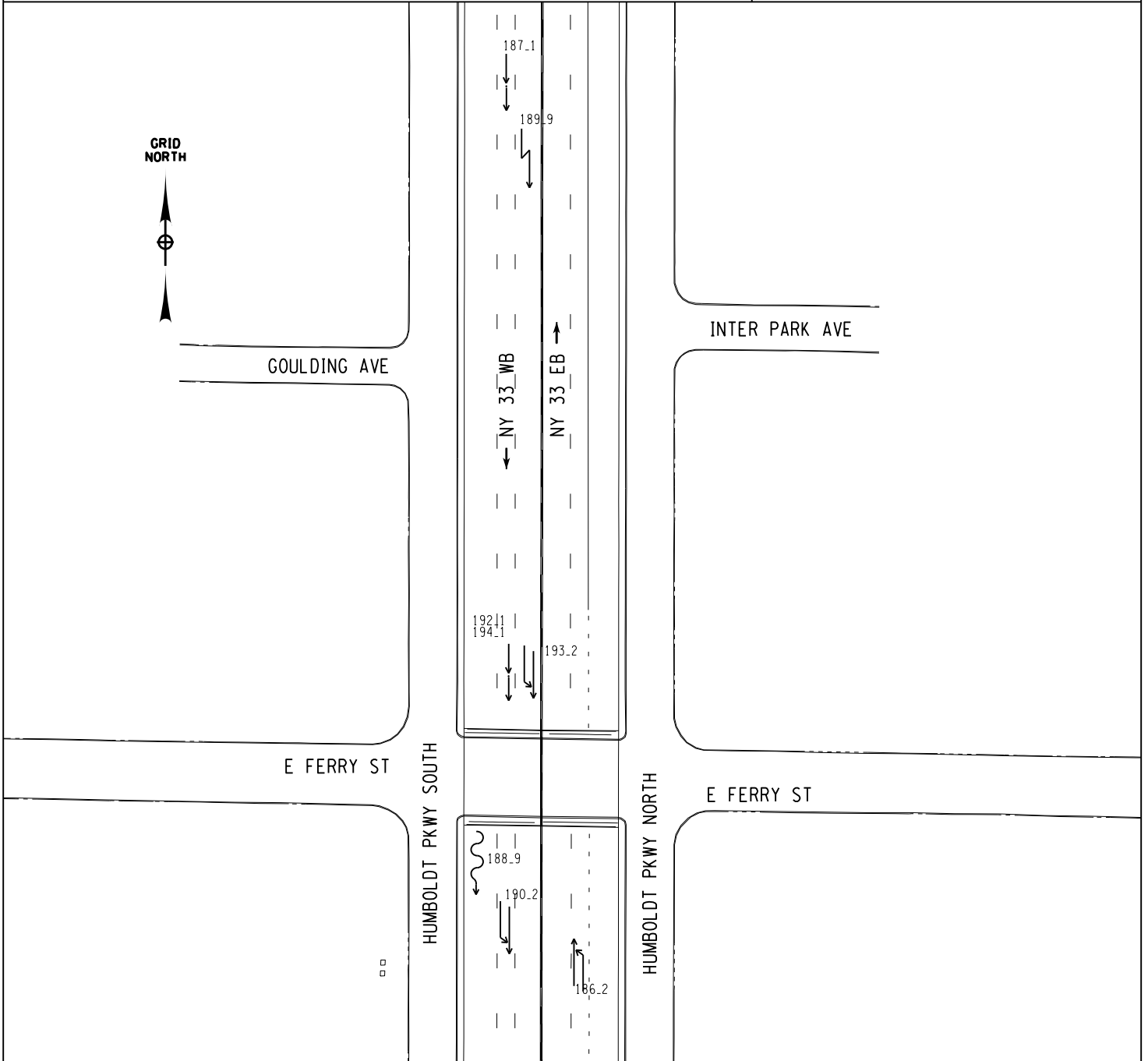

SYMBOLS

<ul style="list-style-type: none"> ← MOVING VEHICLE ← M ← MOTORCYCLE ← → → → BACKING VEHICLE ← ● STOPPED VEHICLE ▭ PARKED VEHICLE 	<ul style="list-style-type: none"> ← - - PEDESTRIAN ← B BICYCLE □ FIXED OBJECT ○ PERSONAL INJURY ● FATAL INJURY
--	--

MANNER OF COLLISION

<ul style="list-style-type: none"> ← ← REAR-END ← → SIDE-SWIPE ← ~ OUT OF CONTROL ← ~ SKIDDING ← ○ OVERTURNED 	<ul style="list-style-type: none"> → → HEAD-ON → ↙ LEFT-TURN → ↓ RIGHT-ANGLE
--	---

DEPARTMENT OF TRANSPORTATION COLLISION DIAGRAM

MUNICIPALITY	CITY OF BUFFALO	COUNTY	ERIE	FILE	Exp³ess ay Accident Diag³ams.dgn
INTERSECTION	KENSINGTON EXPRESSWAY - NY33				
PERIOD	3 YR 0 MO	FROM	08 / 01 / 2013	TO	07 / 31 / 2016
		BY	CAE	DATE	4 / 11 / 2017

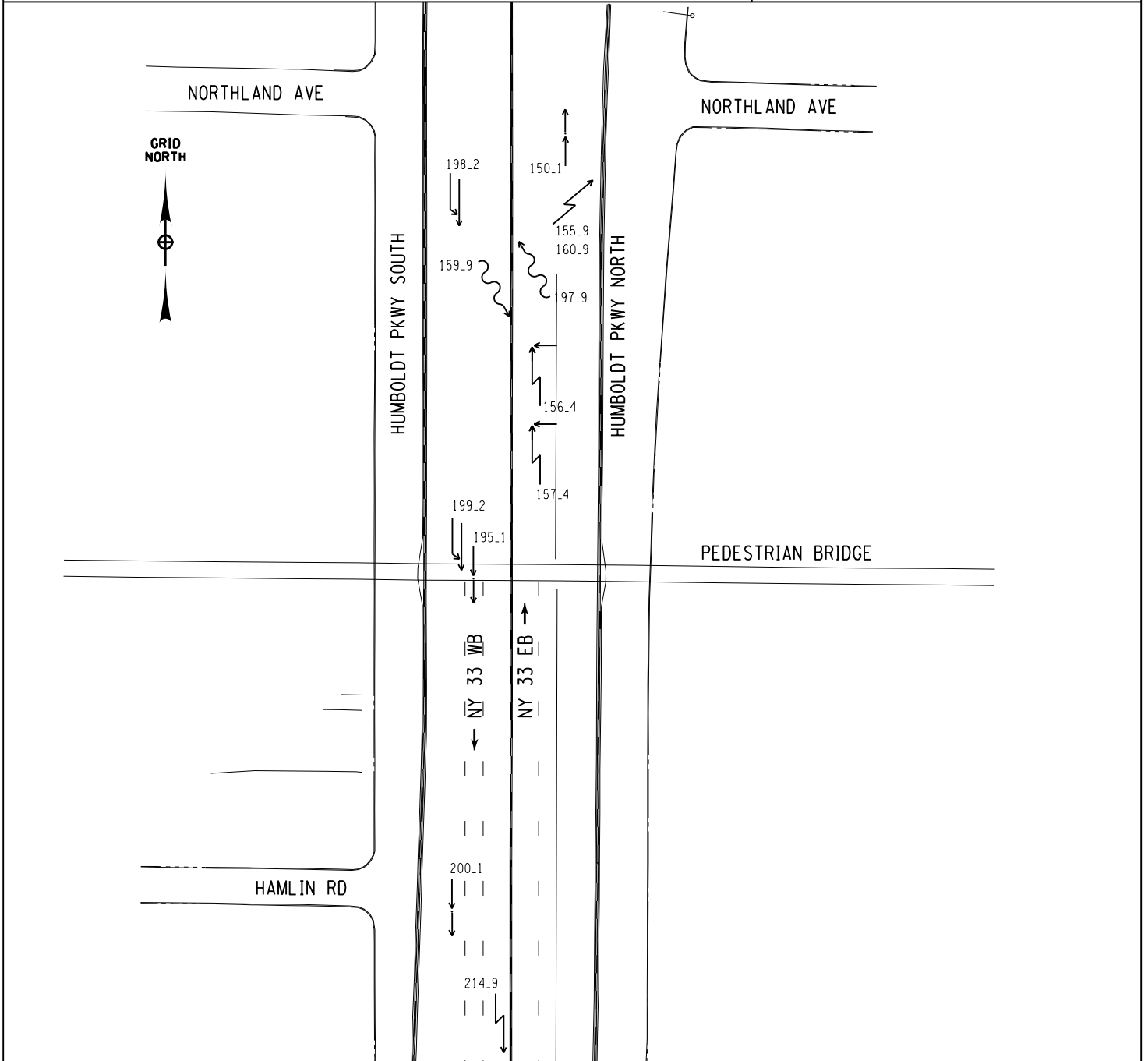

SYMBOLS

<ul style="list-style-type: none"> ← MOVING VEHICLE ← M ← MOTORCYCLE ← → → → BACKING VEHICLE ← ● STOPPED VEHICLE ▭ PARKED VEHICLE 	<ul style="list-style-type: none"> ← - - PEDESTRIAN ← B - BICYCLE □ FIXED OBJECT ○ PERSONAL INJURY ● FATAL INJURY
--	--

MANNER OF COLLISION

<ul style="list-style-type: none"> ← ← REAR-END ← → SIDE-SWIPE ← ~ OUT OF CONTROL ← ⚡ SKIDDING ← ○ OVERTURNED 	<ul style="list-style-type: none"> → → HEAD-ON → ↙ LEFT-TURN → ↓ RIGHT-ANGLE
--	---

DEPARTMENT OF TRANSPORTATION COLLISION DIAGRAM

MUNICIPALITY	CITY OF BUFFALO	COUNTY	ERIE	FILE	ACCIDENT DIAGRAMS.DGN
INTERSECTION	BEST STREET AT NY 33 WB RAMPS				
PERIOD	3 YR 0 MO	FROM	08 / 01 / 2013	TO	07 / 31 / 2016
		BY	CAE	DATE	04 / 11 / 2017

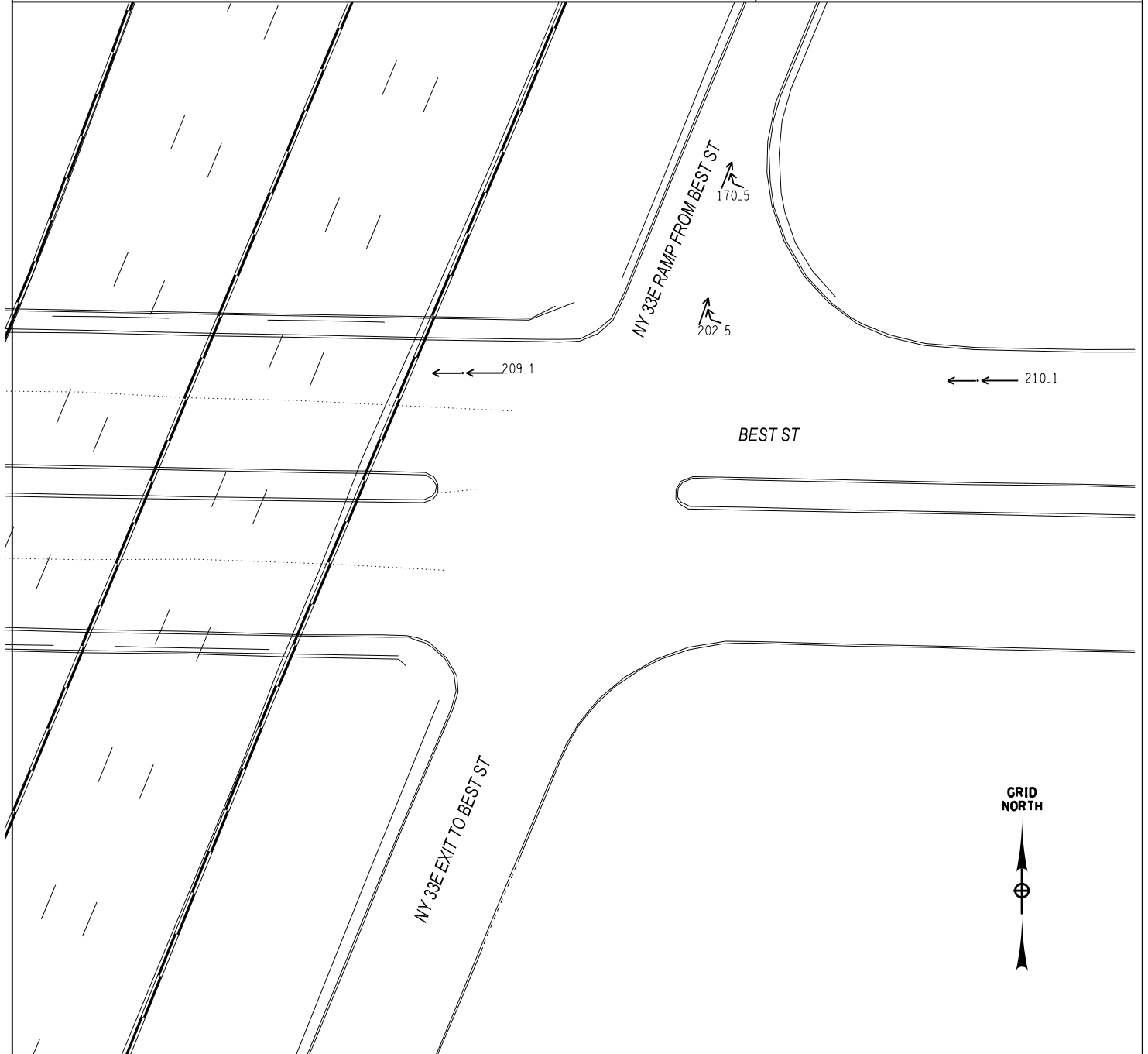

SYMBOLS

- | | |
|---|--|
| <ul style="list-style-type: none"> ← MOVING VEHICLE ← M — MOTORCYCLE ↔↔↔↔ BACKING VEHICLE ← ● STOPPED VEHICLE ▭ PARKED VEHICLE | <ul style="list-style-type: none"> ← - - - PEDESTRIAN ← B — BICYCLE □ FIXED OBJECT ○ PERSONAL INJURY ● FATAL INJURY |
|---|--|

MANNER OF COLLISION

- | | |
|---|--|
| <ul style="list-style-type: none"> ←← REAR-END ←↔ SIDE-SWIPE ←~ OUT OF CONTROL ←⚡ SKIDDING ←○ OVERTURNED | <ul style="list-style-type: none"> →← HEAD-ON ↔↔ LEFT-TURN ↔↓ RIGHT-ANGLE |
|---|--|

DEPARTMENT OF TRANSPORTATION COLLISION DIAGRAM

MUNICIPALITY	CITY OF BUFFALO	COUNTY	ERIE	FILE	ACCIDENT DIAGRAMS.DGN
INTERSECTION	BEST STREET AT NY 33 WB RAMPS				
PERIOD	3 YR 0 MO	FROM	08 / 01 / 2013	TO	07 / 31 / 2016
		BY	CAE	DATE	04 / 11 / 2017

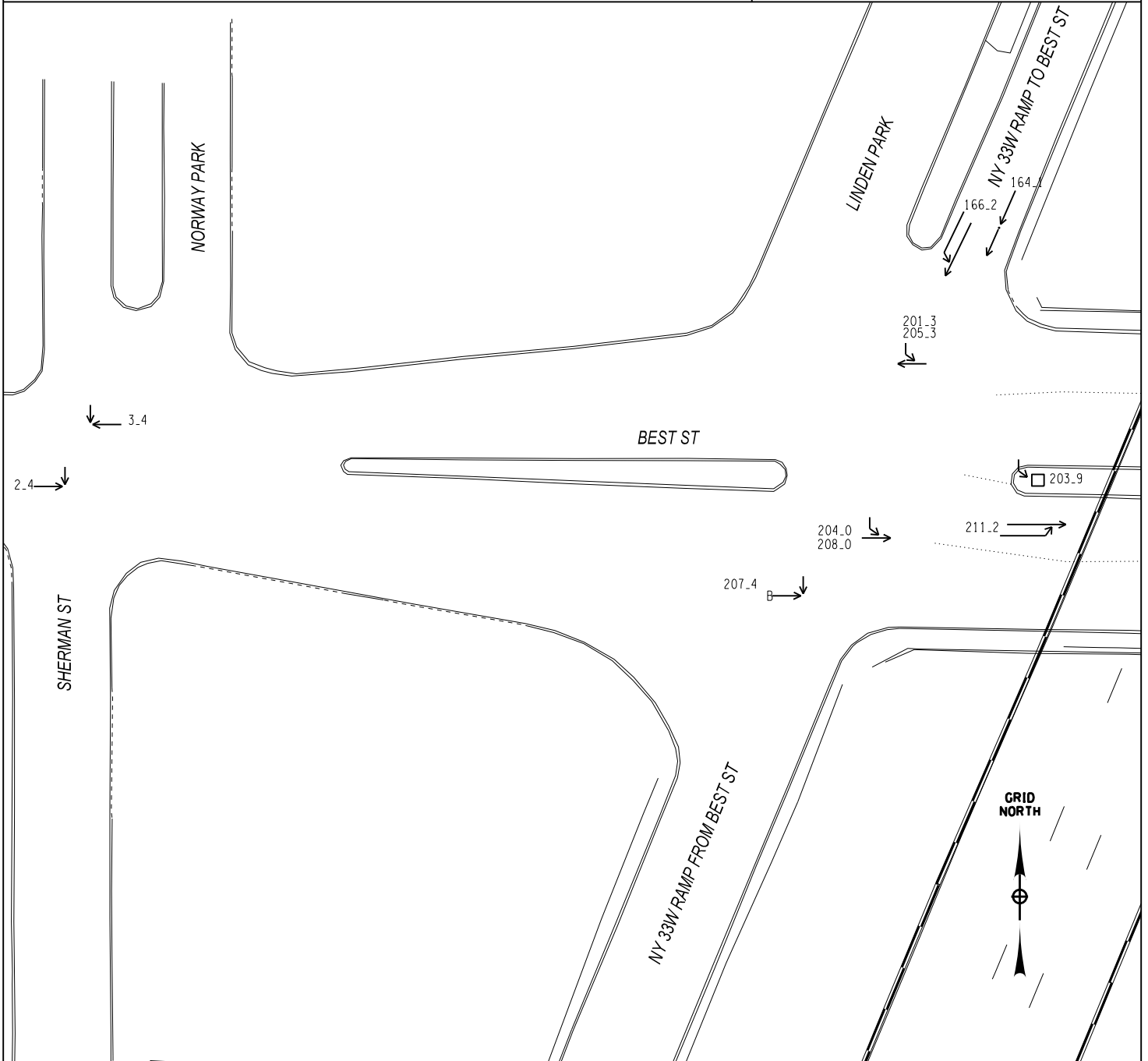

SYMBOLS

<ul style="list-style-type: none"> ← MOVING VEHICLE ← M ← MOTORCYCLE ← → → → BACKING VEHICLE ← ● STOPPED VEHICLE ▭ PARKED VEHICLE 	<ul style="list-style-type: none"> ← - - PEDESTRIAN ← B ← BICYCLE □ FIXED OBJECT ○ PERSONAL INJURY ● FATAL INJURY
--	--

MANNER OF COLLISION

<ul style="list-style-type: none"> ← ← ← REAR-END ← → SIDE-SWIPE ← ~ OUT OF CONTROL ← ~ SKIDDING ← ○ OVERTURNED 	<ul style="list-style-type: none"> → → → HEAD-ON → ↙ LEFT-TURN → ↓ RIGHT-ANGLE
--	---

DEPARTMENT OF TRANSPORTATION COLLISION DIAGRAM

MUNICIPALITY	CITY OF BUFFALO	COUNTY	ERIE	FILE	ACCIDENT DIAGRAMS.DGN
INTERSECTION	BEST STREET AT NY 33 WB RAMPS				
PERIOD	3 YR 0 MO	FROM	08 / 01 / 2013	TO	07 / 31 / 2016
		BY	CAE	DATE	04 / 11 / 2017

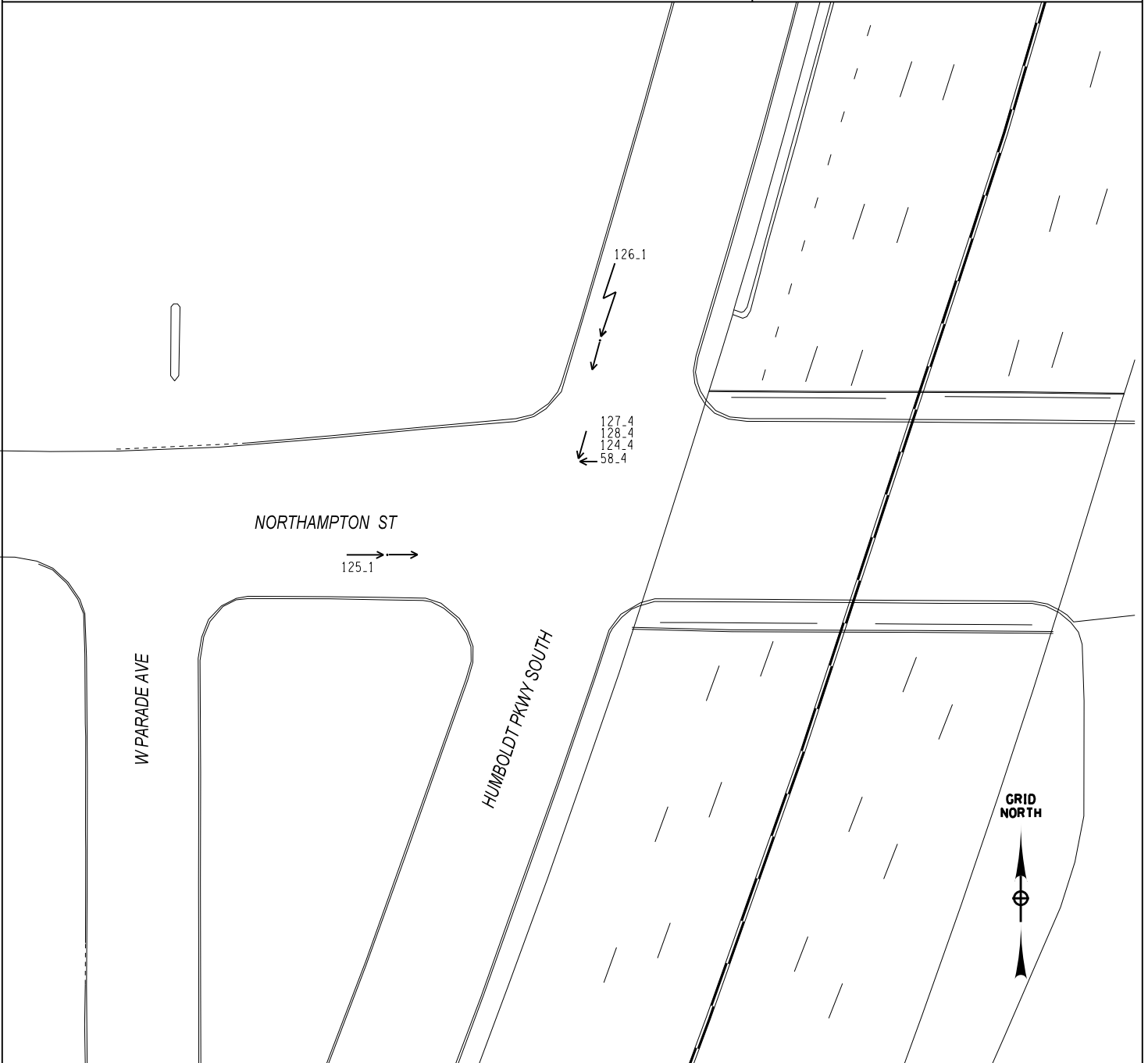

SYMBOLS

- | | |
|--|--|
| <ul style="list-style-type: none"> ← MOVING VEHICLE ← M — MOTORCYCLE ↔↔↔↔ BACKING VEHICLE ←● STOPPED VEHICLE ▭ PARKED VEHICLE | <ul style="list-style-type: none"> ← - - - PEDESTRIAN ← B — BICYCLE □ FIXED OBJECT ○ PERSONAL INJURY ● FATAL INJURY |
|--|--|

MANNER OF COLLISION

- | | |
|---|--|
| <ul style="list-style-type: none"> ←← REAR-END ←↔ SIDE-SWIPE ←~ OUT OF CONTROL ←⚡ SKIDDING ←○ OVERTURNED | <ul style="list-style-type: none"> ↔← HEAD-ON ↔↔ LEFT-TURN ↔↓ RIGHT-ANGLE |
|---|--|

DEPARTMENT OF TRANSPORTATION COLLISION DIAGRAM

MUNICIPALITY	CITY OF BUFFALO	COUNTY	ERIE	FILE	ACCIDENT DIAGRAMS.DGN
INTERSECTION	BEST STREET AT NY 33 WB RAMPS				
PERIOD	3 YR 0 MO	FROM	08 / 01 / 2013	TO	07 / 31 / 2016
		BY	CAE	DATE	04 / 11 / 2017

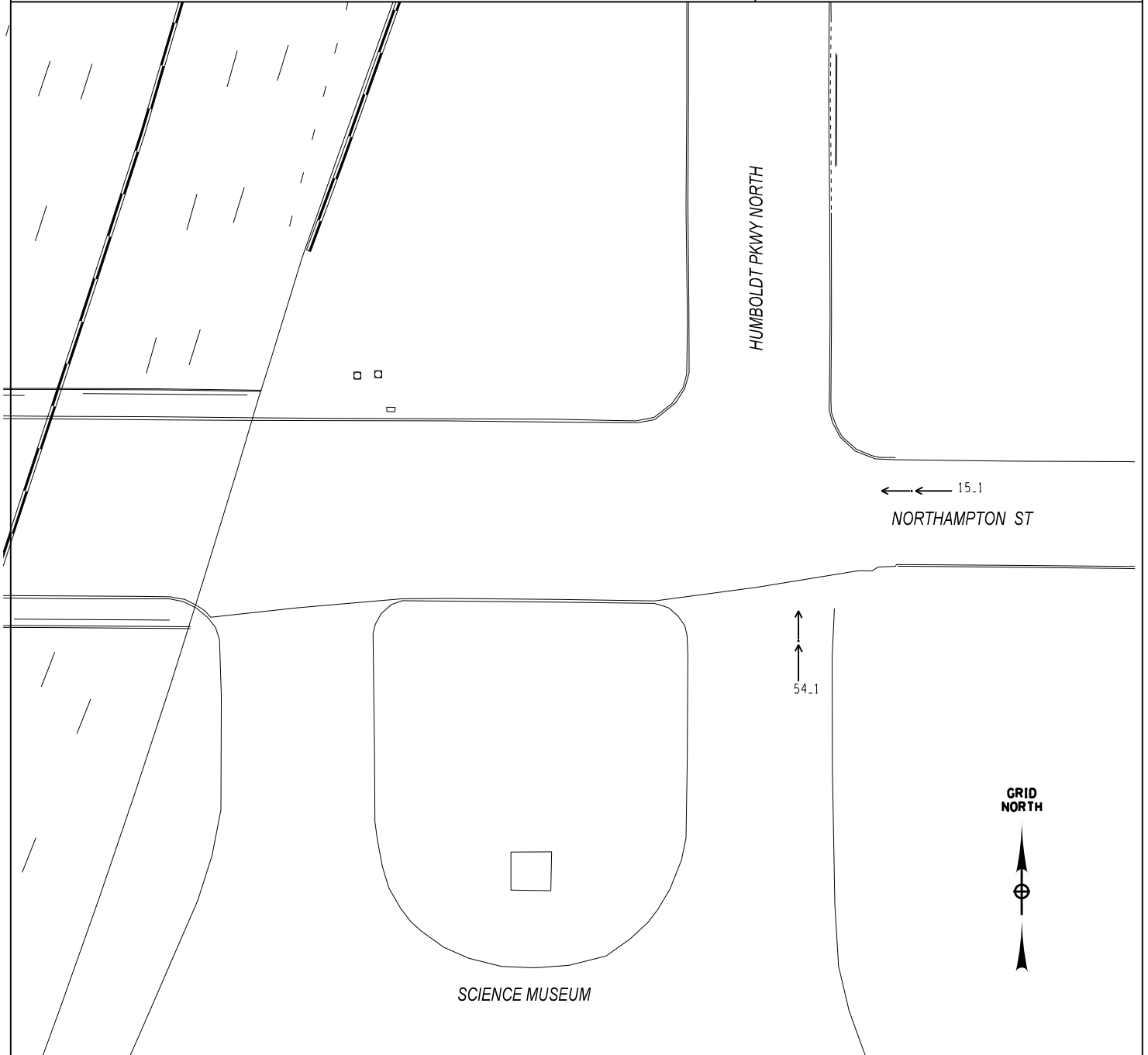

SYMBOLS

- | | |
|---|--|
| <ul style="list-style-type: none"> ← MOVING VEHICLE ← M — MOTORCYCLE ↔↔↔↔ BACKING VEHICLE ← ● STOPPED VEHICLE ▭ PARKED VEHICLE | <ul style="list-style-type: none"> ← - - - PEDESTRIAN ← B — BICYCLE □ FIXED OBJECT ○ PERSONAL INJURY ● FATAL INJURY |
|---|--|

MANNER OF COLLISION

- | | |
|--|---|
| <ul style="list-style-type: none"> ← ← REAR-END ← ← SIDE-SWIPE ← ~ OUT OF CONTROL ← ↘ SKIDDING ← ○ OVERTURNED | <ul style="list-style-type: none"> → ← HEAD-ON → ↘ LEFT-TURN → ↓ RIGHT-ANGLE |
|--|---|

DEPARTMENT OF TRANSPORTATION COLLISION DIAGRAM

MUNICIPALITY	CITY OF BUFFALO	COUNTY	ERIE	FILE	ACCIDENT DIAGRAMS.DGN
INTERSECTION	BEST STREET AT NY 33 WB RAMPS				
PERIOD	3 YR 0 MO	FROM	08 / 01 / 2013	TO	07 / 31 / 2016
		BY	CAE	DATE	04 / 11 / 2017

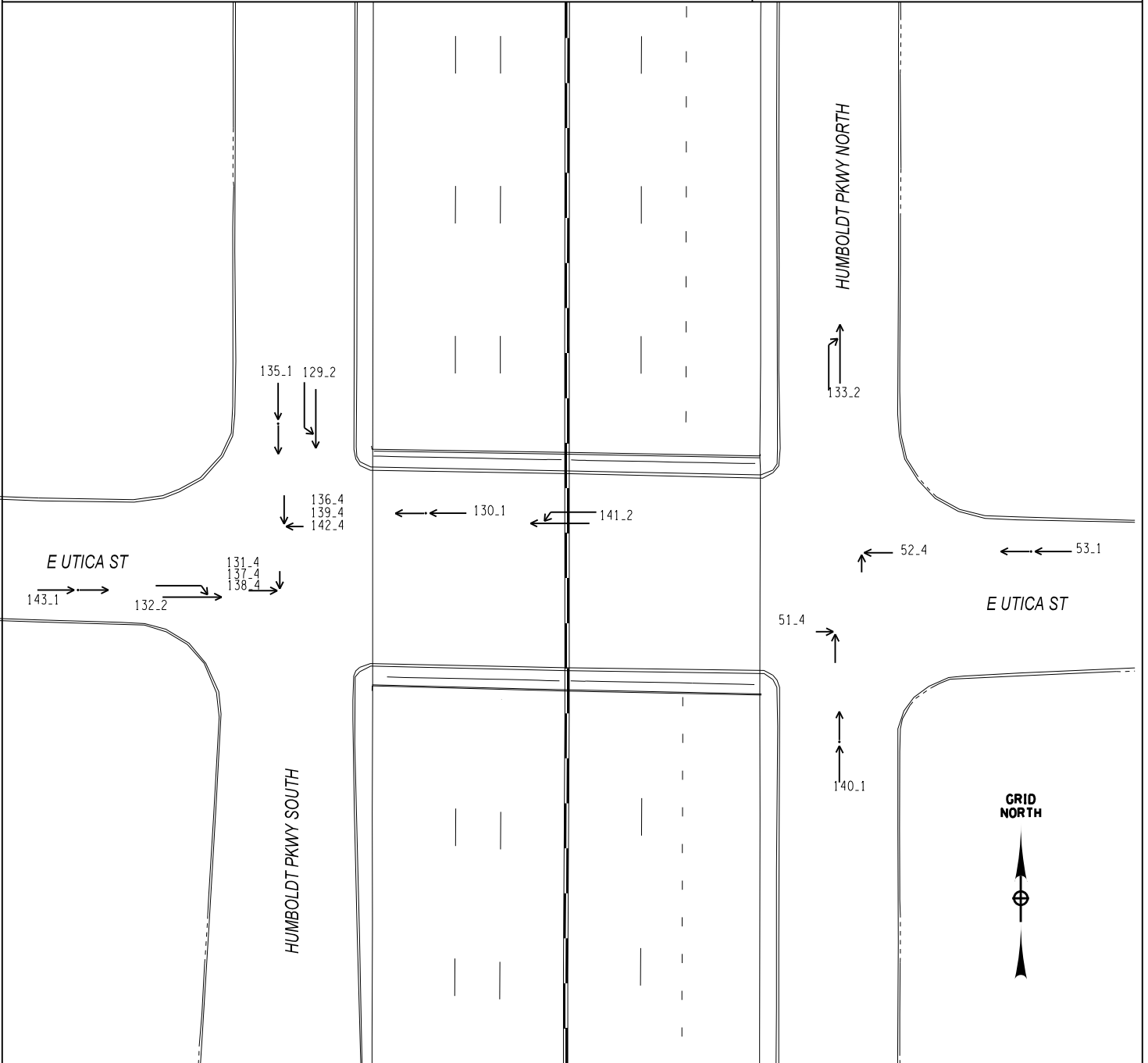

SYMBOLS

- | | |
|--|--|
| <ul style="list-style-type: none"> ← MOVING VEHICLE ← M — MOTORCYCLE ↔↔↔↔ BACKING VEHICLE ←● STOPPED VEHICLE ▭ PARKED VEHICLE | <ul style="list-style-type: none"> ← - - PEDESTRIAN ← B — BICYCLE □ FIXED OBJECT ○ PERSONAL INJURY ● FATAL INJURY |
|--|--|

MANNER OF COLLISION

- | | |
|---|--|
| <ul style="list-style-type: none"> ←← REAR-END ←↔ SIDE-SWIPE ←~ OUT OF CONTROL ←⚡ SKIDDING ←○ OVERTURNED | <ul style="list-style-type: none"> ↔← HEAD-ON ↔↘ LEFT-TURN ↔↓ RIGHT-ANGLE |
|---|--|

DEPARTMENT OF TRANSPORTATION COLLISION DIAGRAM

MUNICIPALITY	CITY OF BUFFALO	COUNTY	ERIE	FILE	ACCIDENT DIAGRAMS.DGN
INTERSECTION	BEST STREET AT NY 33 WB RAMPS				
PERIOD	3 YR 0 MO	FROM	08 / 01 / 2013	TO	07 / 31 / 2016
		BY	CAE	DATE	04 / 11 / 2017

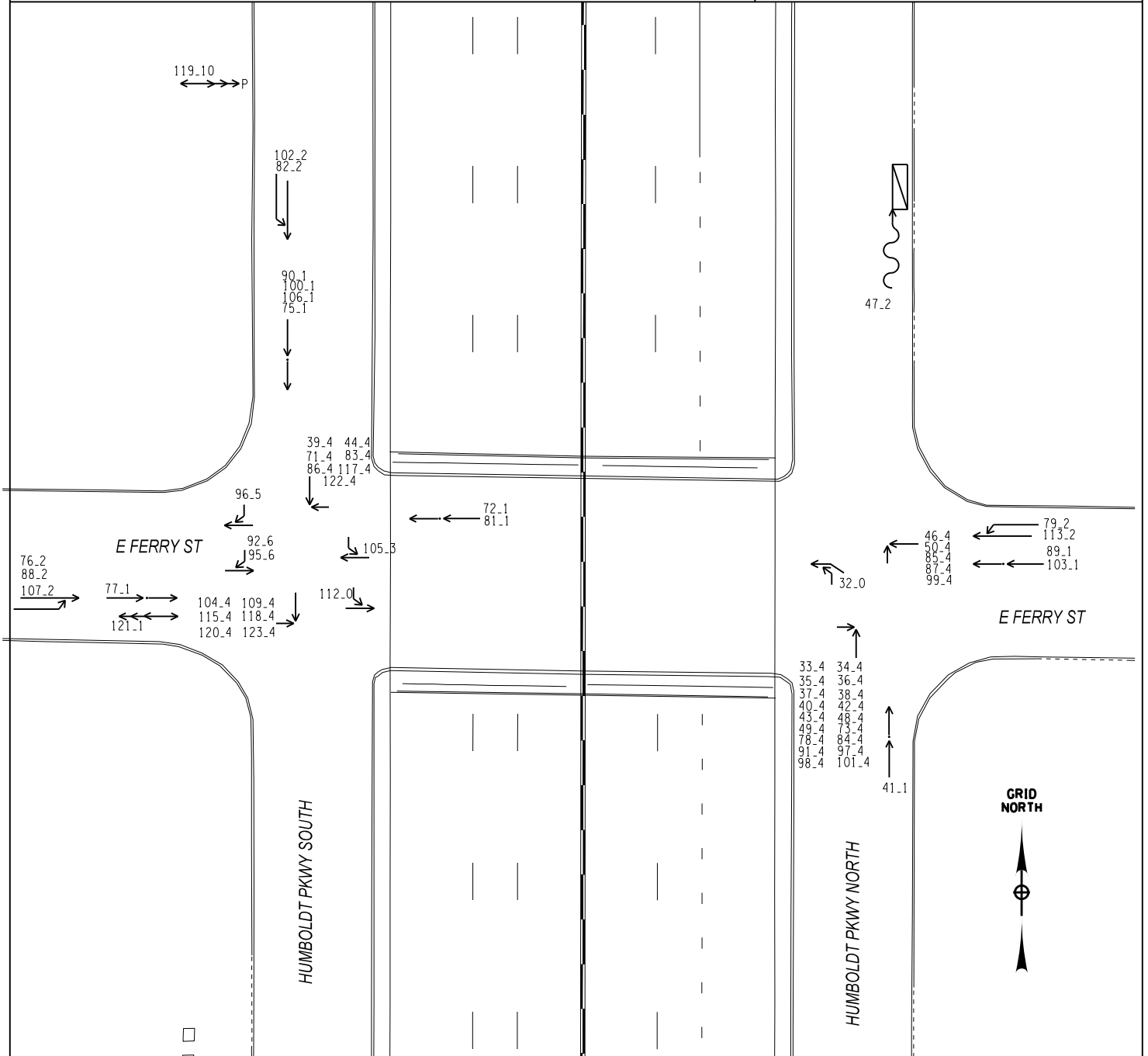

SYMBOLS

- | | |
|--|--|
| <ul style="list-style-type: none"> ← MOVING VEHICLE ← M — MOTORCYCLE ↔ BACKING VEHICLE ← ● STOPPED VEHICLE □ PARKED VEHICLE | <ul style="list-style-type: none"> ← - - PEDESTRIAN ← B — BICYCLE □ FIXED OBJECT ○ PERSONAL INJURY ● FATAL INJURY |
|--|--|

MANNER OF COLLISION

- | | |
|--|---|
| <ul style="list-style-type: none"> ← ← REAR-END ← ← SIDE-SWIPE ← ~ OUT OF CONTROL ← ← SKIDDING ← ○ OVERTURNED | <ul style="list-style-type: none"> → ← HEAD-ON ← ↘ LEFT-TURN → ↓ RIGHT-ANGLE |
|--|---|